

KEY MAP

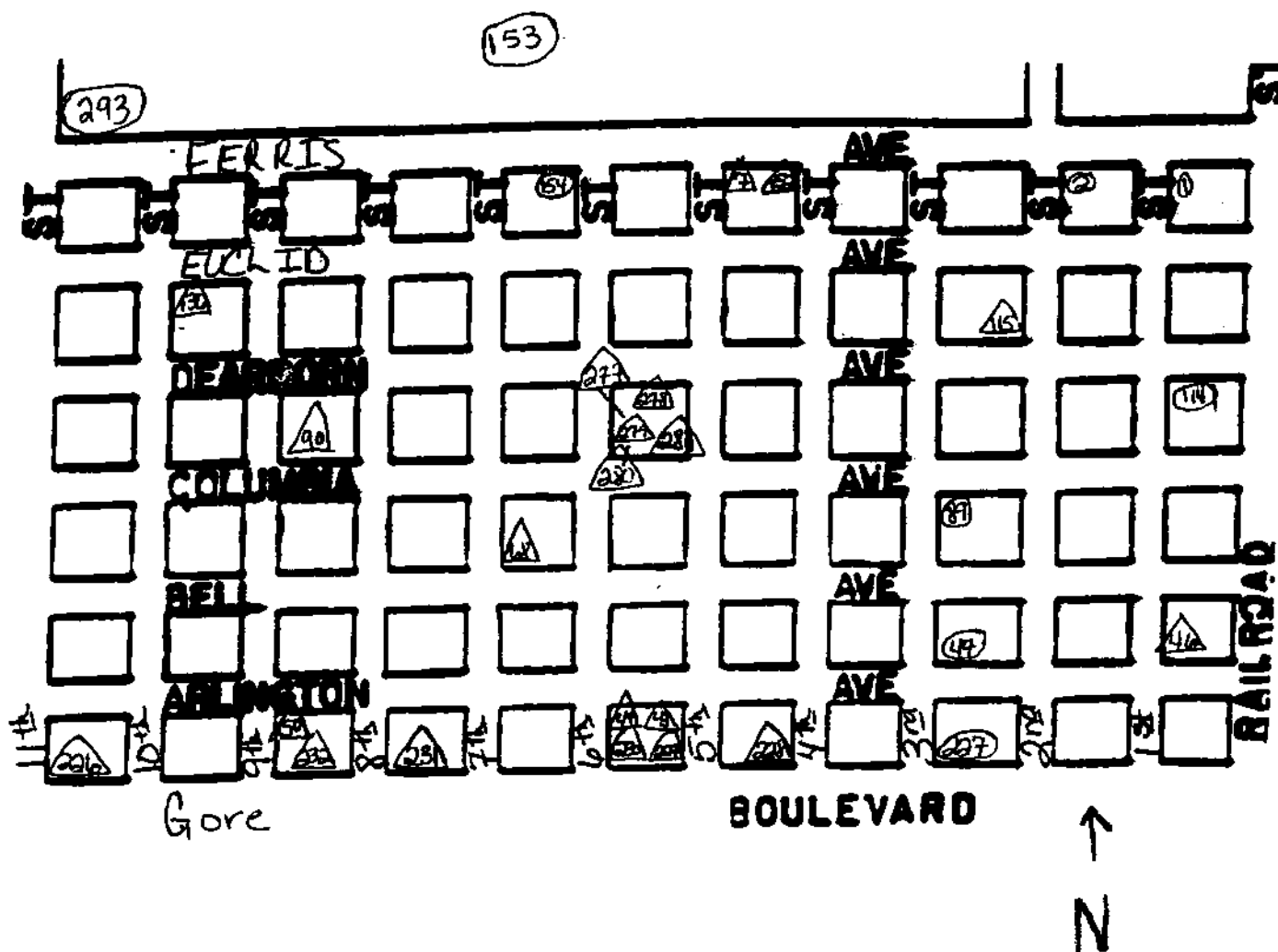

AREA MAP B

- = Does not warrant further study
- △ = Warrants further study
- = National Register property

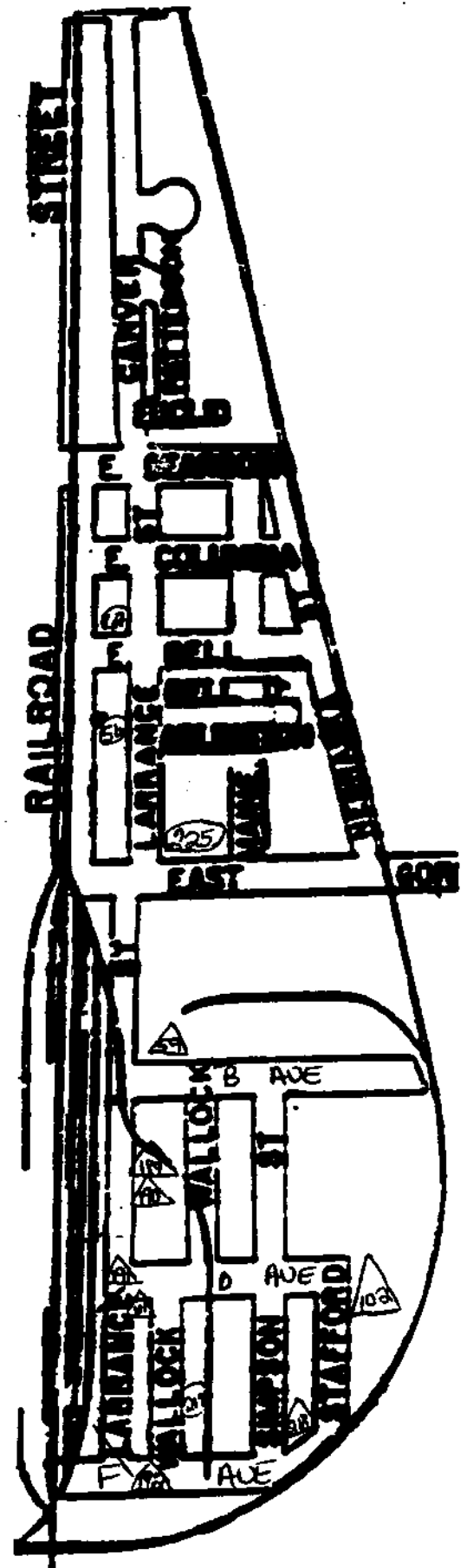

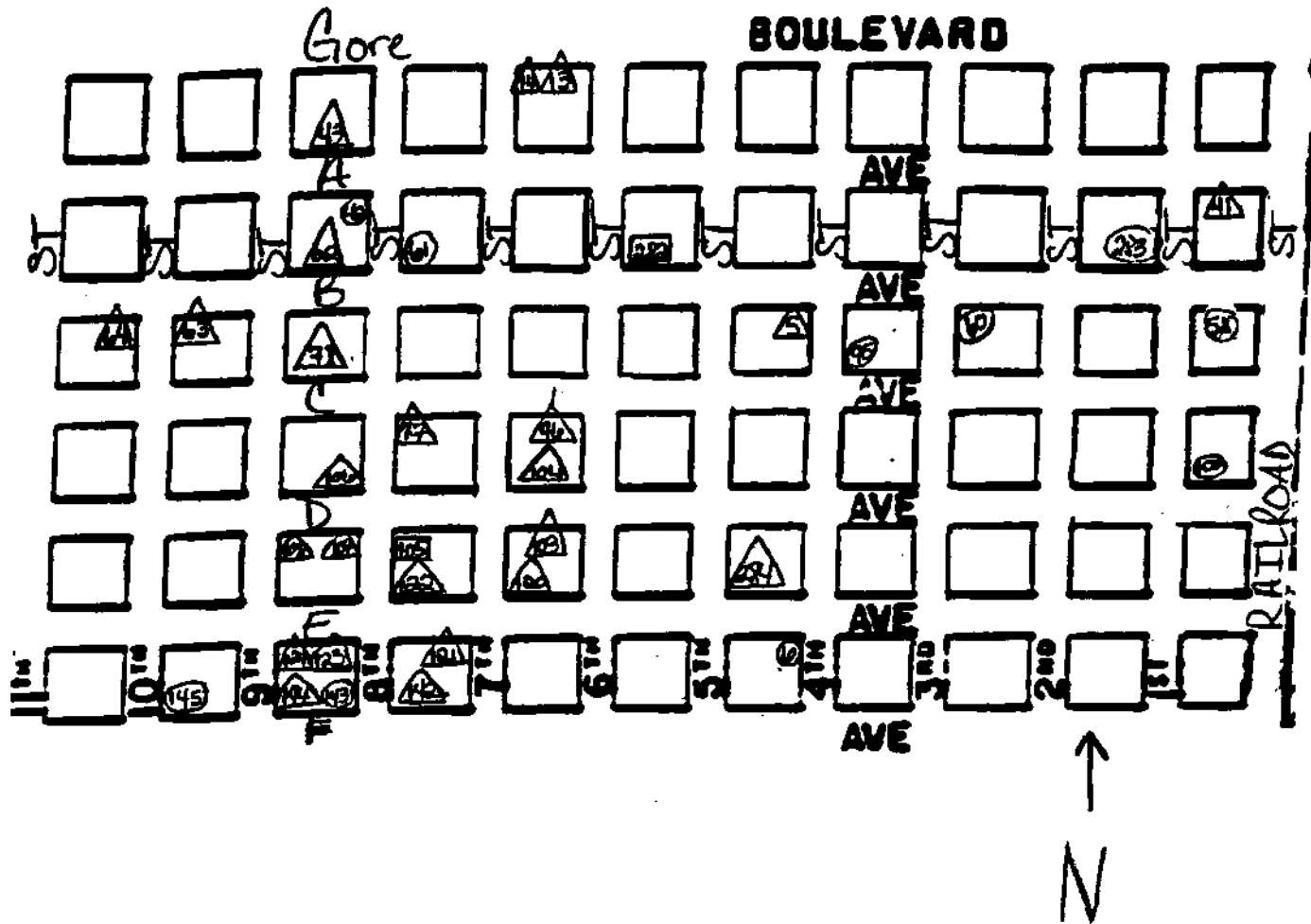

AREA MAP C

- = Does not warrant further study
- △ = Warrants further study
- = National Register property

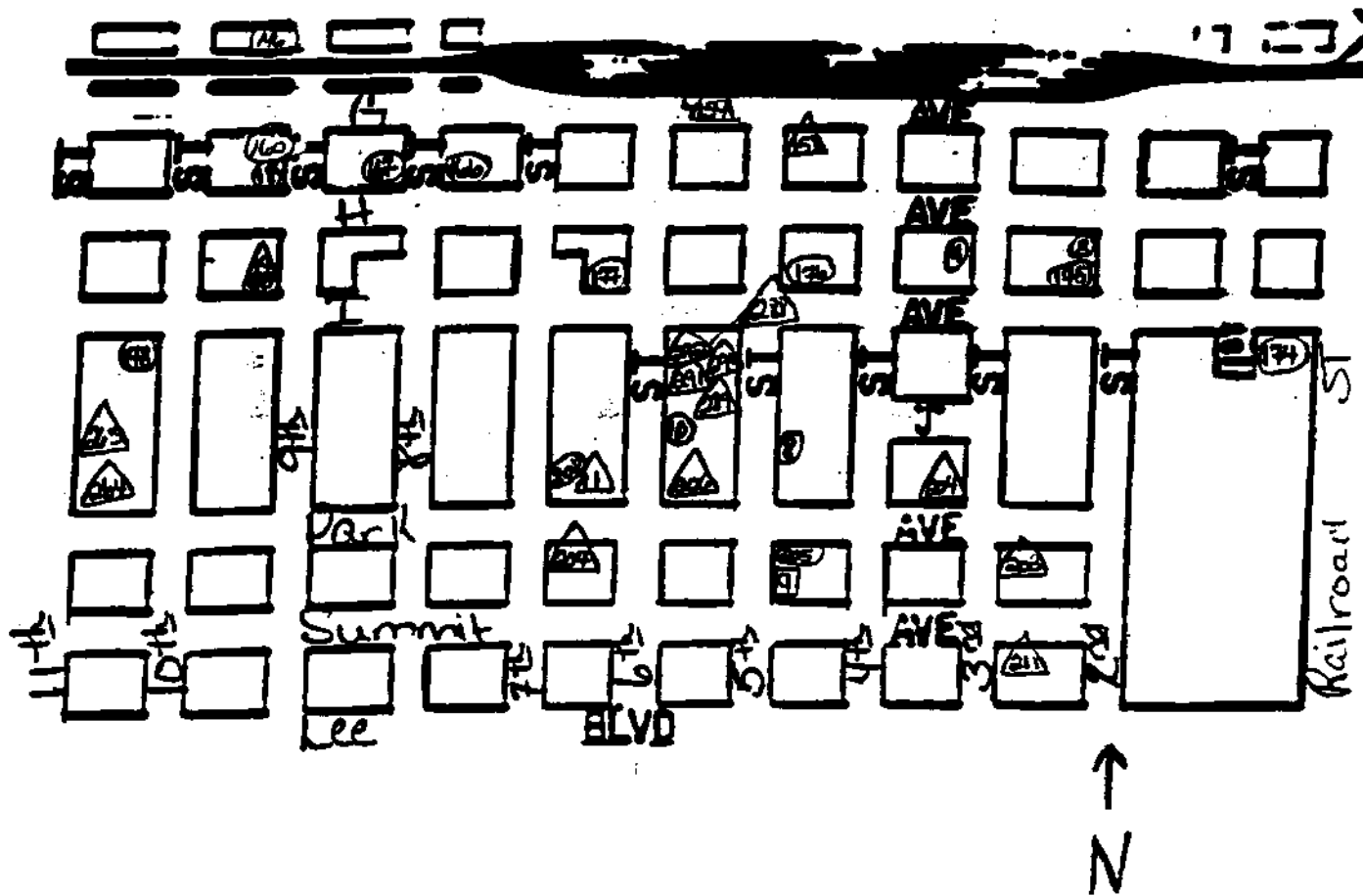

AREA MAP D

- - Does not warrant further study
- △ - Warrants further study
- = National Register property

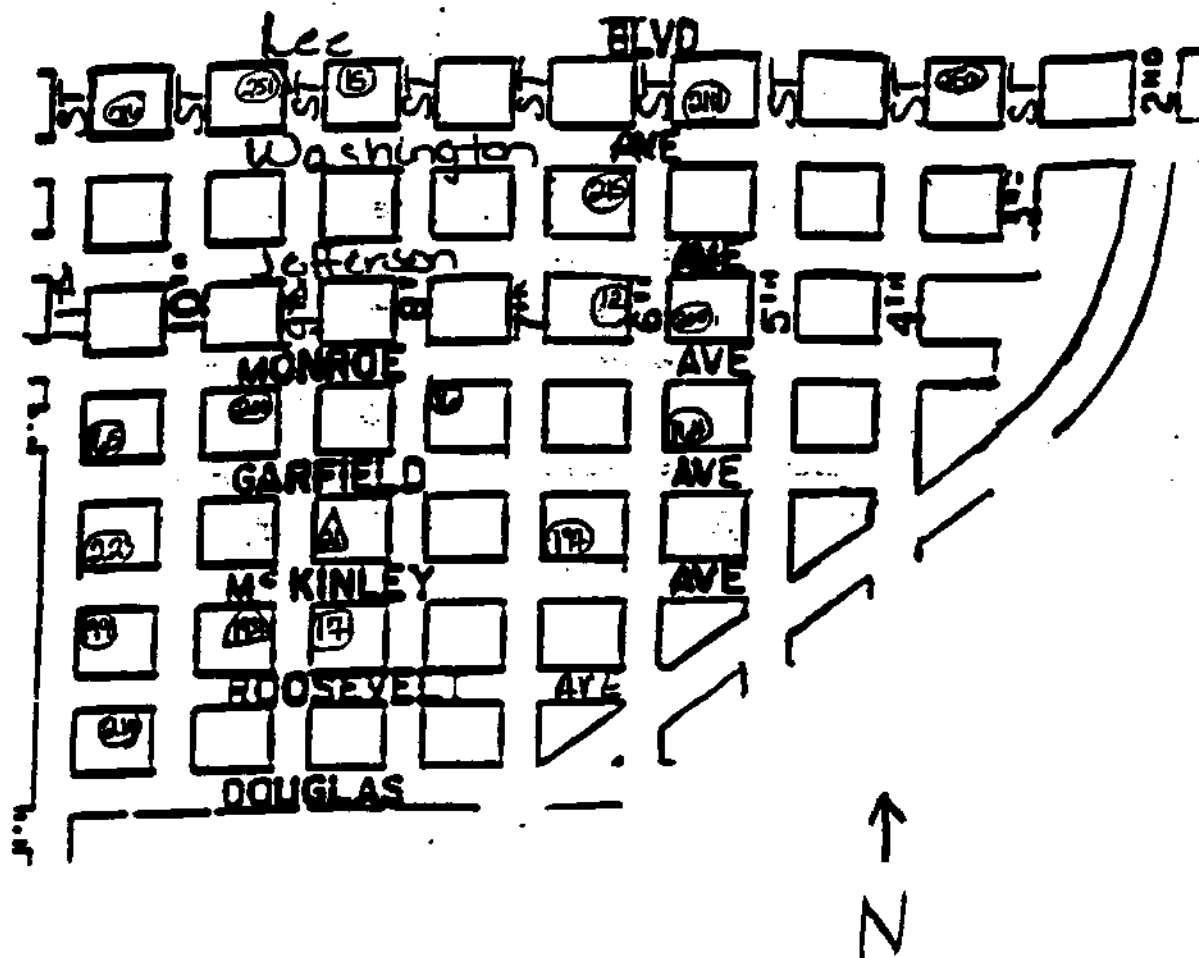

AREA MAP E

- = Does not warrant further study
- Δ = Warrants further study
- = National Register property

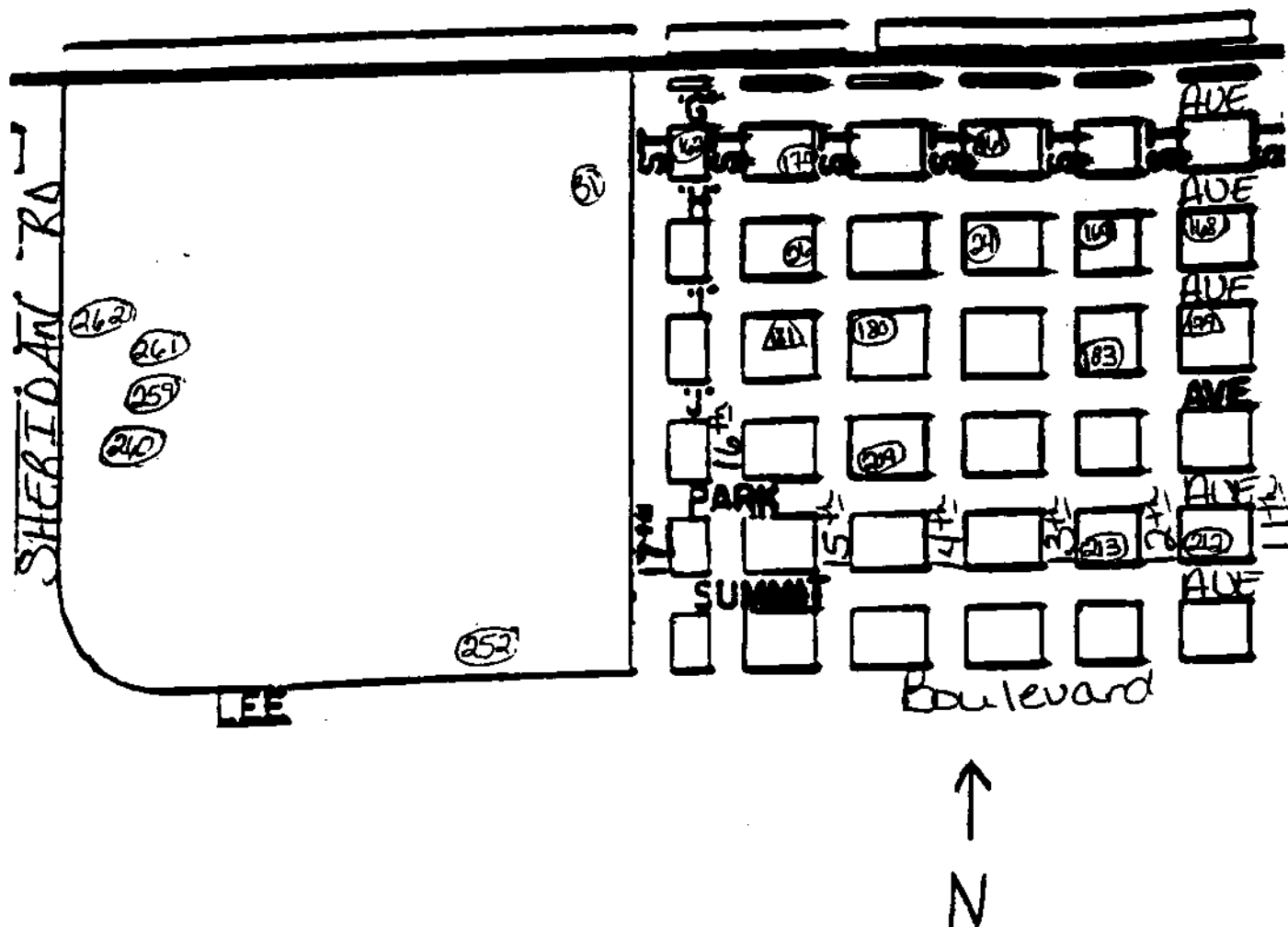

AREA MAP F

- = Does not warrant further study
- △ = Warrants further study
- = National Register property

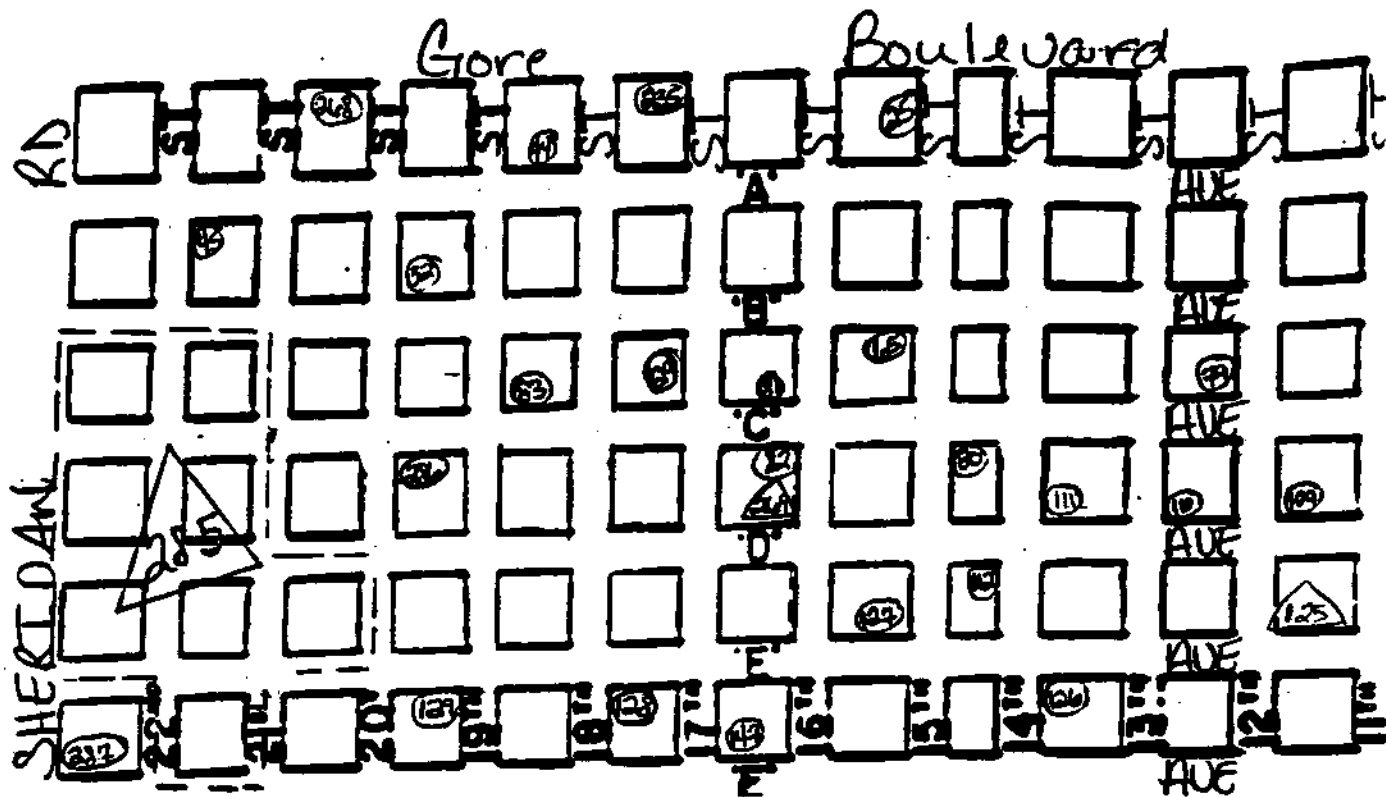

AREA MAP H

- = Does not warrant further study
- △ = Warrants further study
- = National Register property

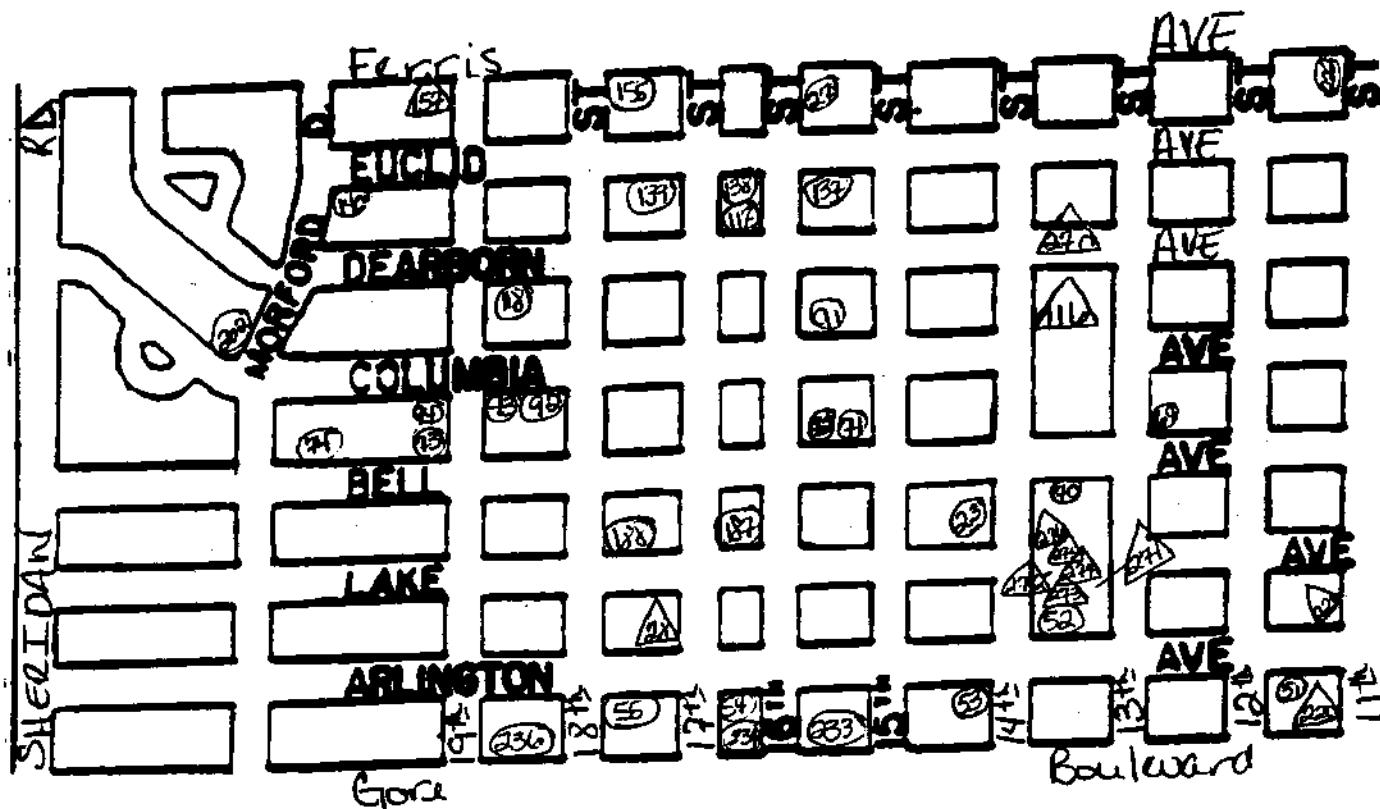

AREA MAP I

- = Does not warrant further study
- △ = Warrants further study
- = National Register property

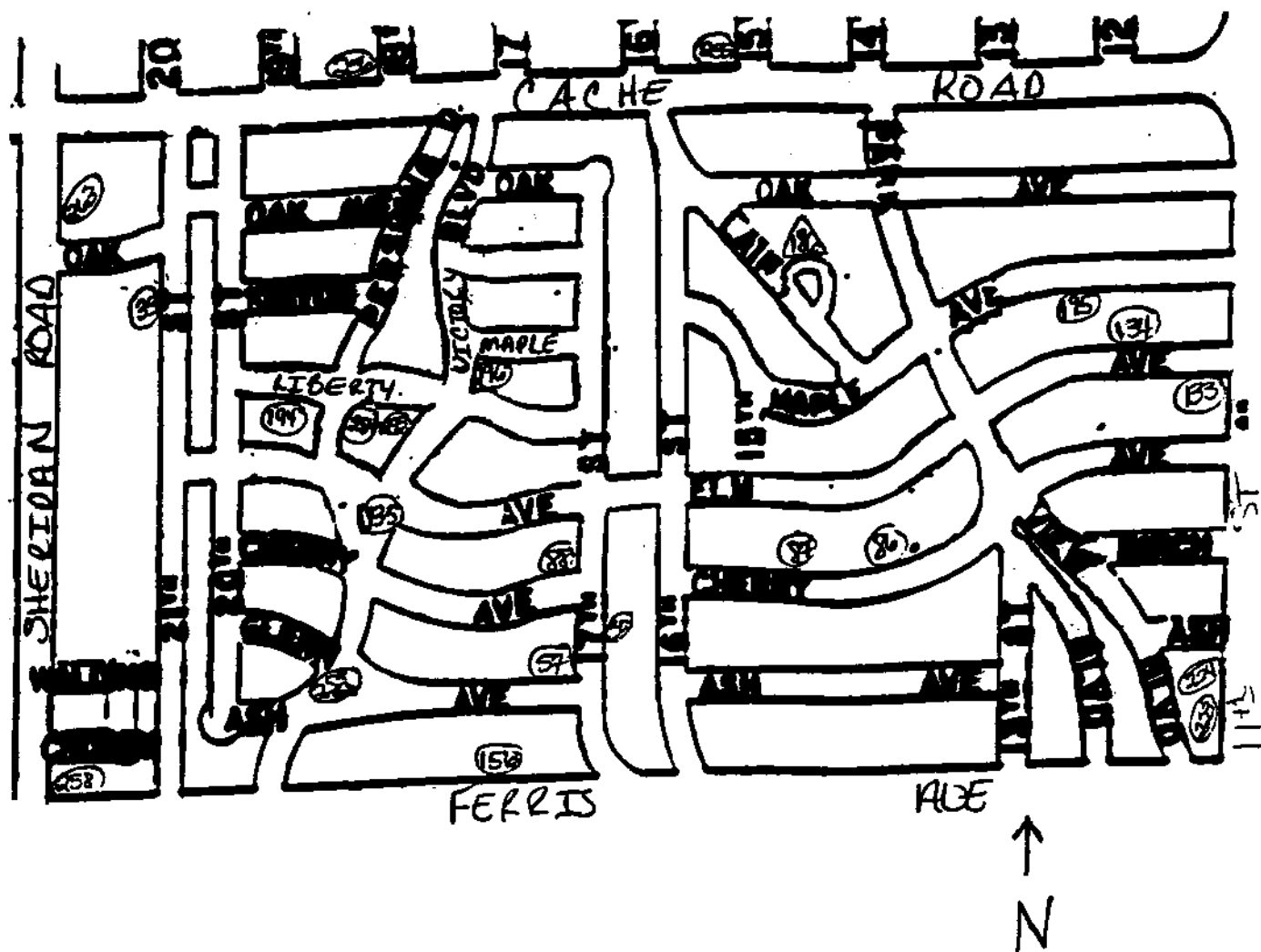

AREA MAP J

- = Does not warrant further study
- △ = Warrants further study
- = National Register property

INDIVIDUAL PROPERTIES AND DISTRICTS WARRANTING FURTHER STUDY

Individual Properties

The list which follows indicates the individual properties documented during the survey which, on the basis of their age and integrity, were deemed worthy of possible inclusion on the National Register. Some of these properties are also included in the possible district identified during the project. Since the exact composition of such a district potentially could change as part of a formal National Register nomination, their additional listing as individual properties is appropriate.

The format for the listing is the same as the section listing all documented properties, so that section may be consulted as a key for the information provided. The maps depicting the location of these individual properties also follows that section.

Resource Name: Address: <u>Photograph:</u>	<u>Map Coordinate:</u>
Federal Recreation Building 201 S.W. 4th Street 24 LAW 22, 23, 24	005
Dale House 507 N.W. 5th Street 5 LAW 18, 19	007
Lincoln School 921 S.W. 6th Street 1 LAW 5, 6	011
St. Mary's Academy 8 S.W. 7th Street 7 LAW 14, 15	013
Blessed Sacrament Catholic Church 12 S.W. 7th Street 7 LAW 16, 17	014
Sasser's Grocery and Market 807 S.W. 9th Street 2 LAW 22, 23	019
Will Rogers Elementary School 1608 S.W. 9th Street 20 LAW 23, 24	021
Woodrow Wilson Elementary School 102 N.W. 17th Street 12 LAW 22, 23, 24	028
16 S.W. A Avenue 16 S.W. A Avenue 23 LAW 27, 28	041
807 S.W. A Avenue 807 S.W. A Avenue 5 LAW 2, 3	043
Faith Temple Church 15 N.W. Arlington Avenue 23 LAW 7, 8	046
Best House 502 N.W. Arlington Avenue 6 LAW 18, 19	048
Jackson House 516 N.W. Arlington Avenue 6 LAW 20, 21	049
Kilpatrick House 810 N.W. Arlington Avenue 6 LAW 3,4	050

Resource Name: Address: <u>Photograph:</u>	<u>Map Coordinate:</u>
LarRance Tank Manufacturers 101 S.E. B Avenue 26 LAW 5, 6, 15	059
Walter Wolverton House 807 S.W. B Avenue 4 LAW 0, 1	062
912 S.W. B Avenue 912 S.W. B Avenue 25 LAW 6, 7, 8	063
1002 S.W. B Avenue 1002 S.W. B Avenue 25 LAW 3, 4, 5	064
Barber House 611 N.W. Bell Avenue 6 LAW 15, 16	068
Angus Hospital 614 S.W. C Avenue 3 LAW 22, 23	076
McMahon Foundation Building 716 S.W. C Avenue 25 LAW 1, 2	077
Central Junior High 809 S.W. C Avenue 3 LAW 24, 25	078
Washington Elementary School 805 N.W. Columbia Avenue 5 LAW 22, 23	090
Great Plains Recycling 202 S.E. D Avenue 24 LAW 11, 14	101
Katy-K Office and Sales Department 310 S.E. D Avenue 24 LAW 17, 18, 19	102
J.M. Jones Building 612 S.W. D Avenue 4 LAW 16, 17	103
Central Fire Station 623 S.W. D Avenue 3 LAW 20, 21	104
Leslie Powell House 801 S.W. D Avenue 4 LAW 6, 7	106

Resource Name: Address: <u>Photograph:</u>	<u>Map Coordinate:</u>
Benbow House 816 S.W. D Avenue 4 LAW 22, 23	108
LaSill Milk Company Building 201 N.W. Dearborn Avenue 23 LAW 1, 2	115
Roosevelt Stadium 301 N.W. Dearborn Avenue 10 LAW 13, 14	116
706 S.W. E Avenue 706 S.W. E Avenue 24 LAW 31, 32	121
709 S.W. E Avenue 709 S.W. E Avenue 24 LAW 33, 34, 35	122
804 S.W. E Avenue 804 S.W. E Avenue 24 LAW 27, 28	123
812 S.W. E Avenue 812 S.W. E Avenue 24 LAW 29, 30	124
1115 S.W. E Avenue 1115 S.W. E Avenue 19 LAW 7, 8	125
A. T. Howell Elementary School 2402 S.W. E Avenue 14 LAW 34, 35	131
Montgomery House 916 N.W. Euclid Avenue 5 LAW 14, 15	136
707 S.W. F Avenue 707 S.W. F Avenue 2 LAW 14, 15	142
815 S.W. F Avenue 815 S.W. F Avenue 2 LAW 10, 11	144
Sneed House 402 N.W. Ferris Avenue 5 LAW 12, 13	152

Resource Name: Address: <u>Photograph:</u>	<u>Map Coordinate:</u>
608 N.W. Ferris Avenue 608 N.W. Ferris Avenue 5 LAW 10, 11	154
Vaska Theatre 1902 N.W. Ferris Avenue 13 LAW 23, 24	157
426 S.W. G Avenue 426 S.W. G Avenue 22 LAW 15, 16	158
Billingslea Lumber 505 S.W. G Avenue 22 LAW 13, 14	159
Laborers Local Union 495 Building 1116 S.W. I Avenue 19 LAW 31, 32	179
Roosevelt Elementary School 1502 S.W. I Avenue 19 LAW 19, 20	181
Whittier Elementary 1115 N.W. Laird (N.W. Laird and Oak) 3 LAW 32, 33	186
Chickasha Feed Mill 228 S.E. Larrance Avenue 24 LAW 8, 9	189
Power's Steam Sales and Service 302 S.E. Larrance Avenue 24 LAW 10	190
Best Beer Company Building 405 S.E. Larrance Avenue 24 LAW 6, 7	191
Group Home 902 S.W. McKinley Avenue 25 LAW 11, 12	198
216 S.W. Park Avenue 216 S.W. Park Avenue 21 LAW 29, 30	203
301 S.W. Park Avenue 301 S.W. Park Avenue 21 LAW 31, 32	204

Resource Name: Address: <u>Photograph:</u>	<u>Map Coordinate:</u>
First Mattie Beal Residence 511 S.W. Park Avenue 1 LAW 2, 3, 4	206
Beal Heights Presbyterian Church 614 S.W. Park Avenue 1 LAW 7, 8	207
212 S.W. Summit Avenue 212 S.W. Summit Avenue 21 LAW 27, 28	211
Lawton Spring & Welding Company 430 S.E. Simpson Street 24 LAW 15, 16	218
English House 10 N.W. Fort Sill Boulevard 7 LAW 6, 7	220
Quinette House 102 N.W. Fort Sill Boulevard 7 LAW 8, 9	221
Braum's Ice Cream Shop 608 N.W. Fort Sill Boulevard 12 LAW 2, 3	222
Gill House 113 S.W. Gore Boulevard 23 LAW 35; 24 LAW 1	226
Red Cross 401 S.W. Gore Boulevard 3 LAW 28, 29	228
Fields House 501 S.W. Gore Boulevard 6 LAW 22, 23	229
Myers House 509 S.W. Gore Boulevard 7 LAW 0, 1	230
Lattimore House 707 S.W. Gore Boulevard 7 LAW 2, 3	231
Ross House 807 S.W. Gore Boulevard 7 LAW 4, 5	232
Grounds Building 2800 S.W. Gore Boulevard 14 LAW 32, 33	239

Resource Name: Address: <u>Photograph:</u>	<u>Map Coordinate:</u>
Physical Facilities Shop 2800 S.W. Gore Boulevard 13 LAW 29, 30	240
South Hall 2800 S.W. Gore Boulevard 25 LAW 13, 14, 15	241
Cameron Hall 2800 S.W. Gore Boulevard 25 LAW 16, 17	242
Gate 2800 S.W. Gore Boulevard 14 LAW 7, 8	246
WPA Bridge S.W. 11th Street and S.W. Park Avenue 2 LAW 1,2	264
Reeves Grocery S.W. 16th Street and S.W. D Avenue 19 LAW 5, 6	269
13th Street & Dearborn Bridge N.W. 13th Street and N.W. Dearborn Avenue 10 LAW 15, 16, 17, 18	070
Harmon Park Site N.W. 13th Street and N.W. Bell Avenue 10 LAW 7, 8, 9, 10	271
Arch N.W. 13th Street and N.W. Bell Avenue 9 LAW 28, 29	272
Benches/Tables N.W. 13th Street and N.W. Bell Avenue 10 LAW 1, 2, 3, 4	273
WPA Bridge N.W. 13th Street and N.W. Bell Avenue 9 LAW 32, 33	274
Dressing Rooms N.W. 13th Street and N.W. Bell Avenue 9 LAW 30, 31	275
Ruins N.W. 13th Street and N.W. Bell Avenue 10 LAW 11, 12	276

Resource Name:

Address:

Photograph:

Map Coordinate:

Legion Park/35th Division Park Site N.W. 6th Street and N.W. Columbia Avenue 5 LAW 20, 21	277
35th Division Park Dressing Rooms N.W. 6th Street and N.W. Columbia Avenue 6 LAW 7, 8	278
35th Division Park Gas Building N.W. 6th Street and N.W. Columbia Avenue 6 LAW 9, 10	279
35th Division Park Pool N.W. 6th Street and N.W. Columbia Avenue 6 LAW 5, 6	280
35th Division Park Planter N.W. 6th Street and N.W. Columbia Avenue 6 LAW 11, 12	281
Federal Building S.W. 5th Street and S.W. E Avenue 3 LAW 16, 17	284
Doe Doe Park S.W. 23rd Street and S.W. D Avenue 17 LAW 14, 15, 16, 17, 18, 19, 20; 26 LAW 11, 12, 13, 14	285
Union Park Site S.W. 6th Street and S.W. I Avenue 1 LAW 24, 25	288
Picnic Table S.W. 6th Street and S.W. I Avenue 1 LAW 22, 23	289
Stage S.W. 6th Street and S.W. I Avenue 1 LAW 20, 21	290
Fountain S.W. 6th Street and S.W. I Avenue 1 LAW 18, 19	291
WPA Archway S.W. 6th Street and S.W. I Avenue 1 LAW 16, 17	292

Districts

The survey identified one potential district within the study, the Old Town North Historic District. This area contains the largest concentration of pre-World War II homes which maintain their integrity. Accordingly, it serves as an important physical link to the city's development between its founding in 1901 and 1940. During and after World War II, Lawton experienced a boom which transformed it into one of the state's major metropolitan areas.

A verbal description of the district boundaries, a list of the documented properties within its, and a map of the district follows.

Boundary description: From the intersection of Fort Sill Boulevard and Ferris Avenue proceed east to Third Street, then south to the north side of West Gore Boulevard, then west to Fort Sill Boulevard, then north to the point of beginning. Except for West Gore Boulevard, which is a divided thoroughfare, the district includes both sides of the bordering streets.

Documented Properties Within the District:

Property Name:

Address:

Photo Negative:

Map Coordinate:

Contributing Resources

Dale House 507 N.W. 5th Street 5 LAW 18, 19	007
Best House 502 N.W. Arlington Avenue 6 LAW 18, 19	048
Jackson House 516 N.W. Arlington Avenue 6 LAW 20, 21	049
Kilpatrick House 810 N.W. Arlington Avenue 6 LAW 3, 4	050
Barber House 611 N.W. Bell Avenue 6 LAW 15, 16	068
Washington Elementary School 805 N.W. Columbia Avenue 5 LAW 22, 23	090
Montgomery House 916 N.W. Euclid Avenue 5 LAW 14, 15	136
Sneed House 402 N.W. Ferris Avenue 5 LAW 12, 13	152
English House 10 N.W. Fort Sill Boulevard 7 LAW 6, 7	220
Quinette House 102 N.W. Fort Sill Boulevard 7 LAW 8, 9	221
Gill House 113 S.W. Gore Boulevard 23 LAW 35; 24 LAW 1	226
Red Cross 401 S.W. Gore Boulevard 3 LAW 28, 29	228
Fields House 501 S.W. Gore Boulevard 6 LAW 22, 23	229
Myers House 509 S.W. Gore Boulevard 7 LAW 0, 1	230

Property Name: Address: <u>Photo Negative:</u>	<u>Map Coordinate:</u>
Lattimore House 707 S.W. Gore Boulevard 7 LAW 2, 3	231
Ross House 807 S.W. Gore Boulevard 7 LAW 4, 5	232
Legion Park/35th Division Park Site N.W. 6th Street and N.W. Columbia Avenue 5 LAW 20, 21	277
35th Division Park Dressing Rooms N.W. 6th Street and N.W. Columbia Avenue 6 LAW 7, 8	278
35th Division Park Gas Building N.W. 6th Street and N.W. Columbia Avenue 6 LAW 9, 10	279
35th Division Park Pool N.W. 6th Street and N.W. Columbia Avenue 6 LAW 5, 6	280
35th Division Park Planter N.W. 6th Street and N.W. Columbia Avenue 6 LAW 11, 12	281
<u>Non-Contributing Resources</u>	
608 N.W. Ferris Avenue 608 N.W. Ferris Avenue 5 LAW 10, 11	154
Braum's Ice Cream Shop 608 N.W. Fort Sill Boulevard 12 LAW 2, 3	222

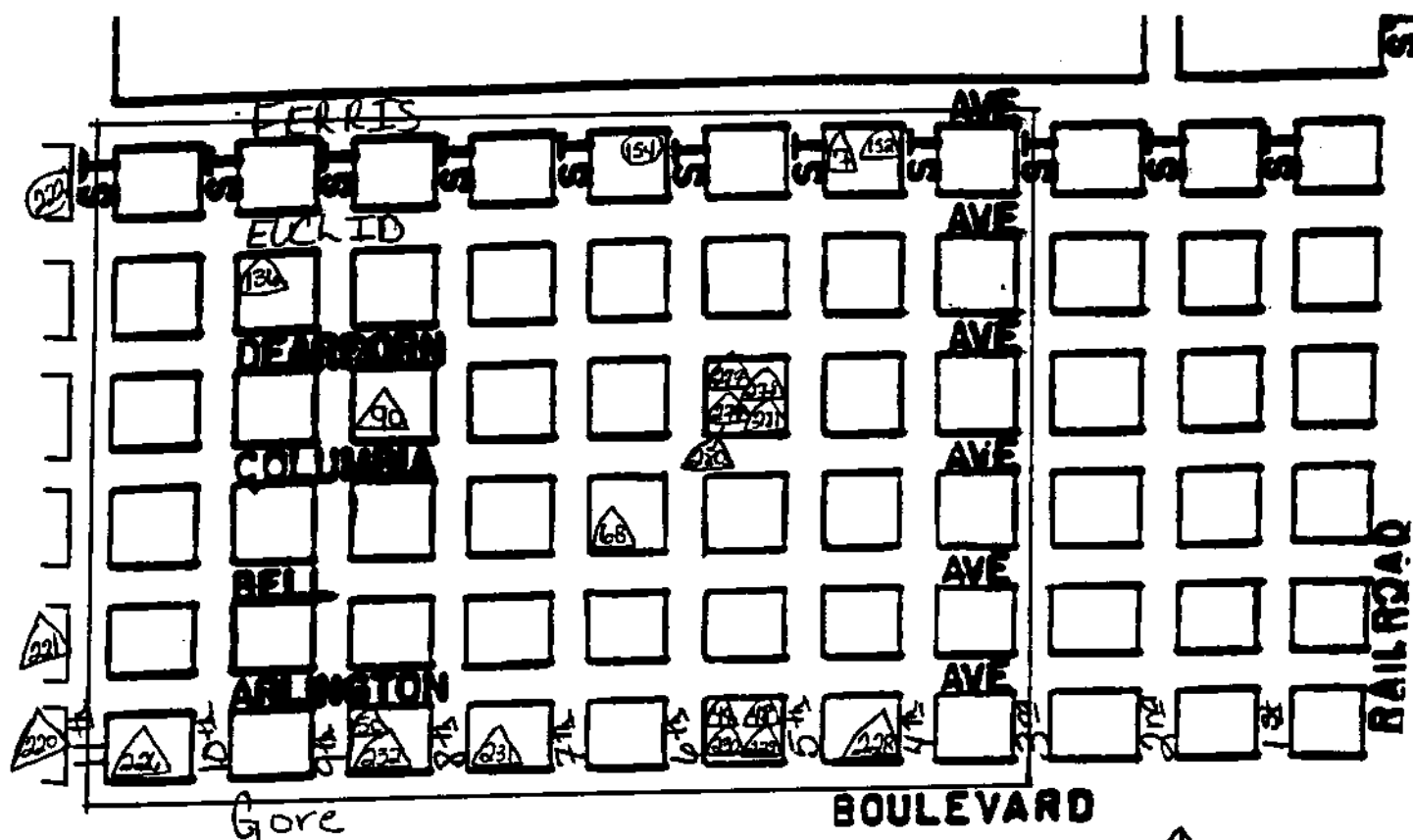

OLD TOWN NORTH HISTORIC DISTRICT

- = Does not warrant further study
- △ = Warrants further study

SUMMARY

The Reconnaissance Level Survey of a Portion of Lawton proved a success. It documented 293 properties in the study area. Of these, 93 properties (31.7%) warrant further study for possible inclusion on the National Register of Historic Places. Moreover, 21 of the properties (7.2%) lie within the potential Old Town North Historic District the survey identified.

For all those properties, a file containing a completed Historic Preservation Resource Identification Form, photodocumentation, and any field notes now exists. These files have been submitted to the State Historic Preservation Office to become part of the Oklahoma Landmarks Inventory. Finally, a diskette containing project data has been submitted to the State Historic Preservation Office to facilitate its entry into a collective data base of significant Oklahoma and national cultural resources.

The Oklahoma Historic Preservation Survey, as the results reflect, fulfilled its contractual obligations in a highly professional manner. In addition to the accomplishments noted above, the Survey also generally increased both the area within Oklahoma inventoried for historic sources, and the number of properties identified. It also markedly increased awareness of resources associated with one of the state's largest metropolitan areas, and as such an area having considerable review and compliance related activity. In all these ways, this project and its products will serve as a valuable tool for the future preservation of these unique resources specifically, and regional land-use management in general.

BIBLIOGRAPHY

Primary

Books

First Christian Church. Diamond Jubilee, 1901-1976. 1976.

History of the First Christian Church, located at 701 D Avenue, Lawton, Oklahoma.

Fraser, Gilbert S. First Annual Report of the Commission-Manager Administration. Lawton, OK; N.P., 1922.

Reports information relative to the operation of the city during 1914 to 1922. Some of the photographs may be of use, such as street scenes and sections of the industrial area.

Lawton, The Wonder Young City--Capital of Comanche, the Wonder Young County of the Wonder Young State, Oklahoma. N.P., 1906.

Promotional history of Lawton published to encourage interest in the town.

Lawrence, Arthur. Lawton Golden Anniversary, 1901-1951. Lawton, OK; N.P., 1951.

Good detailed history of Lawton from 1901 to 1951; including town development, religion, organizations, schools, industries and surrounding attractions.

Lawton Business and Professional Woman's Club. 'Neath the August Sun. Anadarko, OK; N. T. Plummer Printing, c. 1934.

Relates the experiences of the 1901'ers in Lawton through personal stories, poems and songs. It includes streets and businesses in the index.

Robertson Realty Company. Lawton, The Wonder city of the Wonder Section, Oklahoma. St. Louis, MO; Enterprise Addressing Co., 1908.

Promotional history of Lawton, includes many photographs of various buildings.

The Church of Jesus Christ Latter Day Saints Oklahoma State, Lawton Ward. Oklahoma Cemetery Records. Volume 1 and 2, 1963.

Cemetery records of Comanche County. Volume one is exclusively Highland Cemetery in Lawton.

Van Meter, Mrs. Oather E. Methodist Episcopal Church South. Lawton, OK; Oklahoma State Society of the National Society of United States Daughters of 1812, 1981.

Lists the church records of pastors, charter members, church marriages from 1903 to 1912 and the church register from 1901 to 1908. The church changed names several times--1901 South Methodist Church, 1939 Centenary Methodist Church, later Centenary United Methodist Church.

Articles

"A City Rose in a Night." Prairie Lore 24:2 (Fall 1988): 91-93.

Reprint of the 7 September 1901 article from Leslie's Weekly of the opening in Lawton.

Angus, H. A. "The Angus Story." Chronicles of Comanche County 2:1 (Spring 1956): 14-16.

Relates the family history of the Dr. and Mrs. H. A. Angus family who arrived in Lawton in 1905.

Anonymous 1901 Reporter. "Lawton's First Street Fair." Chronicles of Comanche County 1:1 (Spring 1955): 35.

Details the first street fair in Lawton, early June, 1902, by an eyewitness.

Aurell, Mrs. S. W. "Early Days in Lawton." Prairie Lore 11:2 (October 1974): 81-82.

Early experiences in Lawton--moving, husband and wife fight, water problem, various people and the weather.

Austin, Gladys Gray. "Lawton, Yesterday and Today." Chronicles of Comanche County 2:2 (Autumn 1956): 85-87.

Experiences in Lawton and a brief look at what Lawton was like in the early days.

Ayers, E. W. "Everett W. Ayers." Prairie Lore 8:2 (October 1971): 95-97.

Family history, including several years in the Lawton area. Nothing significant about the time in Lawton.

Bice, H. E. "The Good Old Days." Prairie Lore 8:3 (January 1972): 180-181.

Relates experiences in the early days of the county and, very briefly, in Lawton. Includes the City National Bank's location at No. 305 D Avenue.

Bixby, Helen. "Prairie Fire." Chronicles of Comanche County 1:1 (Spring 1955): 38-39.

Tells of the March 1904 prairie fire that went through Lawton; due to the gale winds the town was not destroyed.

Block, Mrs. Eliza A. "Coming to Lawton, 1901." Prairie Lore 10:2 (October 1973): 123.

Reminiscences of early days in Lawton. Mr. Block sold lumber at that time.

Bootner, Mrs. Will. "Goo Goo Avenue, Lawton, Oklahoma." Prairie Lore 3:3 (January 1967): 159.

Experiences in early day Lawton: Goo Goo Avenue was named after a popular show.

Brandon, J. J. "Pioneer Times in Lawton." Prairie Lore 5:1 (July 1968): 18-19.

Story of J. J. Brandon's experiences in Lawton.

Bruss, J. T. "J. T. Bruss--A 1901'er." Prairie Lore 14:3 (January 1978): 183-185.

Personal experiences of the first days in Lawton.

Burton, A. J. "An Early Funeral in Lawton." Prairie Lore 10:2 (October 1973): 124-125.

Relates experiences in Lawton--arriving, first home in the tent city, first church service attended, illegal/immoral activities on Goo Goo Avenue and Mr. Brown's funeral, one of the first in the city. Includes a picture of a street scene in early Lawton.

Cassal, Reverend Hillary. "Missionary Tour in the Chickasaw Nation." Chronicles of Oklahoma 34:4 (Winter 1956-1957): 397-416.

Recounts a visit to Indian Territory in 1885, which included a three day stay at Fort Sill.

Childs, Mr. and Mrs. W. E. "How We Came to Lawton." Prairie Lore 2:4 (April 1966): 189.

Brief story of arriving in Lawton, 1901.

Cooper, Douglas. "A Journal kept by Douglas Cooper of an Expedition by a Company of Chickasaws in quest of Comanche Indians." Chronicles of Oklahoma 5:4 (December 1927): 381-390.

The journal of a soldier extolling the virtues of the military post that became Fort Sill. Introduction and footnotes by Grant Foreman.

Cox, Nora Watson. "Coming to Lawton 1901." Prairie Lore 5:3 (January 1969): 185-189.

Recounts experiences of early days outside of Lawton city limits.

Crane, Mrs. George. "The Crane Story." Chronicles of Comanche County 2:1 (Spring 1956): 26-27.

An account of where and why Mrs. Crane moved to Lawton.

Crosby, J. H. "Early Day Hotels in Lawton." Prairie Lore 13:2 (October 1976): 85-87.

Brief history and chronology of Lawton hotels, from about 1908 to the 1930's.

_____. "Memories of Early Days in Lawton." Prairie Lore 10:3 (January 1973): 179-182.

A good article relating jobs held, store locations, brief descriptions of stores and early day activities in Lawton. Includes picture of the Lawton Steam Laundry delivery van in 1902.

Dale, Edward Everett. "Oklahoma's Great Land Lottery." Great Plains Journal 22 (1983): 2-41.

Relates the history of the 1901 lottery and land opening of the Kiowa-Comanche-Apache and Wichita Reservations; written in 1920.

Day, Margaret. "A Page in History, Lawton, Oklahoma." Prairie Lore 5:3 (January 1969): 180.

Tells of places lived in Lawton when it was the "tent city".

Diehl, H. E. "Pioneer Hardware Merchant." Prairie Lore 13:1 (July 1976): 60.

Recounts brief experiences with Indians.

Dole, Dr. Frank D. to Mr. and Mrs. James Lawrence. "'Lawton Has Been Good to Me'." Chronicles of Comanche County 3:1 (Spring 1957): 32-35.

Experiences of Dr. Frank D. Dole, early Lawton Dentist.

"Events Happening in Lawton." Chronicles of Comanche County 1:2 (Autumn 1955): 79.

Excerpts from The State Democrat, Saturday, November 19, 1904.

Fait, Anna R. "An Autobiography." Chronicles of Oklahoma 32:2 (Summer 1954): 142-184.

Story of Anna R. Fait, who in 1888 had grant for land where Lawton now is but did not receive the money to build a mission so lost the grant.

Ferrell, Mrs. Ed. "Memories of 1901." Prairie Lore 11:2 (October 1974): 97-98.

Relates hardships experienced while homesteading.

Fields, J. H. "The Tent City." Prairie Lore 6:1 (July 1969): 51-52.

Tells of coming to Lawton, selling gasoline in Lawton and homesteading.

Frost, Margaret Fullerton. "Small Girl in a New Town." Great Plains Journal 19 (1980): 2-73; 20 (1981): 3-71; 21 (1982): 3-80.

Relates experiences in and around Lawton from about 1901 to 1918; family history oriented.

Garvin, Mrs. Wilbur. "History of the Beal Heights Presbyterian Church." Chronicles of Comanche County 2:1 (Spring 1956): 28-32.

History of the development and growth of the Beal Heights Presbyterian Church.

Goodner, George E. H. "Experiences in a New Country." Chronicles of Comanche County 2:2 (Autumn 1956): 98-101.

Experiences as a homesteader, including visiting early day Lawton.

_____. "Rough and Ready, Lawton, 1901." Prairie Lore 10:2 (October 1973): 115-122.

Personal story of coming to Lawton, working in a laundry, working as a law clerk, searching for oil and the problem with insects. Includes three photographs of businesses--Baltimore Hotel, 102 C Avenue; Parks Broom Factory, 25 C Avenue; and Citizens State Bank, 226 C Avenue.

Hammond, Dr. C. H. "Early Days at Fort Sill, Oklahoma." Prairie Lore 3:3 (January 1967): 138-140.

Story of attending school and early job as a teamster at Fort Sill in the years of 1893-1901.

Hansen, Caroline. "Across the Sea to Lawton." Prairie Lore 5:1 (July 1968): 50-51.

Story of an immigrant from Denmark who made both runs and operated a boarding house in Lawton after the area was opened to settlers.

Harper, Milburn C. "An Early Day Railroad Agent in the Kiowa-Comanche Country." Chronicles of Oklahoma 33:3 (Autumn 1955): 288-300.

Relates experiences with Indians and the 1901 drawing, concentrating on Hobart, Oklahoma.

Harris, Fred R. "Report of the Building Committee." Chronicles of Comanche County 1:1 (Spring 1955): 40-41.

Discusses the building of a Comanche County Historical Society Museum and Archives building in Lawton.

Holden, J. F. "The B.I.T.: The Story of an Adventure in Railroad Building." Chronicles of Oklahoma 11:1 (March 1933): 637-666.

History of railroads in Oklahoma Territory and Indian Territory before the 1901 land opening.

Holtzclaw, Mrs. R. L. "Prairie Schooner Trip 1901." Prairie Lore 5:1 (July 1968): 23-27.

Romantic look at coming to register for land in 1901.

Hopps, Hon. Howard B. "Lawton Through a Boy's Eyes." Chronicles of Oklahoma 23:3 (Autumn 1945): 293-294.

Glorified reminiscences of the opening and early days in Lawton.

Horne, George W. "Early Day Mining in the Wichitas." Prairie Lore 6:4 (April 1970): 252-253.

Mining in the Wichitas; some of the incidents and problems.

Horton, George. "George Horton's 1901 Experiences." Prairie Lore 5:1 (July 1968): 57-58.

Experiences of a businessman in early day Lawton.

Horton, Mrs. George to Gladys Gray Austin. "'Go West, Young Lady'." Chronicles of Comanche County 2:1 (Spring 1956): 18-21.

Experiences of Mrs. Horton on arriving in Lawton, 1903, and subsequent life experiences--marriage and children.

Iralson, M. "Lawton Land Opening, 1901." Prairie Lore 11:3 (January 1973): 145-149.

Experiences of getting to Lawton and the August 6, 1901 opening.

Keown, Mrs. E. S. "Pre-Lawton Days." Prairie Lore 12:2 (October 1975): 113-116.

Experiences at Fort Sill and with Indians, prior to the opening of Comanche County to white settlers.

Lawrence, Irene Powers. "Pecan School." Chronicles of Comanche County 6:1 (Spring 1960): 37-40.

Recollections and statistics of Pecan School, four miles south and six miles west of the intersection of Lee and 11th Street in Lawton, Oklahoma.

Lebrecht, Ella. "First Dairy in Lawton." Prairie Lore 9:2 (October 1972): 123-124.

Relates the starting of the first dairy; as well as, briefly, the founding of the Hobbs Hotel and other incidents of early days in Lawton.

Leininger, Byll. "Lawton "Langwitch", 1901." Prairie Lore 12:1 (July 1975): 39-41.

Relates the many different cultures present at the opening--German, Spanish, Chinese and Southern.

Linzer, E. H. "Registration and Drawing for Opening of Kiowa and Comanche Country, 1901." Chronicles of Oklahoma 25:3 (Autumn 1947): 289-294.

Personal account of the opening, predominately at El Reno.

Macomber, Izora. "David Calvin Kerby, Pioneer." Prairie Lore 8:3 (January 1972): 145-153.

Family history of the Kerby family, in the Saddle Mountain area.

Masur, Beatrice Keller. "Early Pioneer." Prairie Lore 23:1 (April 1987): 42-43.

Experiences in early day Lawton--riding through the countryside and birth of the first Jewish child in Lawton, 1903.

McClung, Paul. "Lawton's Pioneer Candy Maker, Jack Messinger." Prairie Lore 13:3 (January 1977): 147-149.

Reminiscences of customers at an early day Lawton candy shop.

McCoy, Robert B. "Days of 1901." Prairie Lore 13:2 (October 1976): 122-123.

Personal boyhood reminiscences of the first year in Lawton.

McFarland, Mildred B. "Hugh Hannah." Indian Pioneer Papers 27 (19 August 1937): 345-350.

Recollections of working as a railroad worker before settling in Edmond in 1916. Lawton was considered one of the liveliest frontiers towns.

McGranahan, William. "Early Day Fort Sill Civilian." Prairie Lore 4:2 (October 1967): 116-121.

Recounts several stories of civilians at Fort Sill and what happened to them.

McGregor, W. M. "Memories of an Early Day Banker." Prairie Lore 15:4 (April 1969): 194-199.

Experiences of opening the City National Bank, August 1901, and going from Wichita Falls to Lawton and back.

McMahon, Mrs. E. P. "Reminiscences of Lawton's Early Days." Prairie Lore 13:3 (January 1977): 185-187.

Discusses women settlers and their entertainment in the early days of Lawton and the March 1904 prairie fire.

Merrick, Inez A. "Richard O. Rathbun." Indian Pioneer Papers 70 (29 June 1937): 416-420.

Recounts arriving in Lawton; working for a locating firm locating claims; and homesteading.

Morris, E. S. "E. S. Morris, Fort Sill Pioneer." Prairie Lore 11:2 (October 1974): 117-119; 13:2 (October 1976): 116-118.

Tells of job experiences in Lawton and Fort Sill, 1890 to the 1930's.

Morris, Mrs. T. J. "A Homesteader--1901." Prairie Lore 10:3 (January 1974): 148-150.

Relates mainly to homesteading in Comanche County along Pecan Creek--selling milk and produce. Includes photograph of Fort Sill during the registration period.

Mosley, Minnie. "Minnie Mosley's Recollections." Prairie Lore 13:1 (July 1976): 15.

Family history; in Lawton in the early days.

Norris, Fannie Inez Bell. "Early Days in Lawton Schools." Chronicles of Comanche County 4:2 (Autumn 1958): 90-92.

Memories of attending the early Lawton public schools.

Nunn, CWO (retired) Walter A. "Fort Sill in the 30's and 40's." Prairie Lore 17:2 (April 1981): 78-83.

Experiences in the army and at Fort Sill prior to World War II.

"Oklahoma's Live Young Cities." Sturm's Magazine. 4:3 (May 1907): 10-11.

Brief history of the development of significant towns in Oklahoma, such as Lawton.

Payne, Mattie Beal. "Mattie Beal and the Land Lottery." Prairie Lore 5:1 (July 1968): 9-12.

Story of Mattie Beal Payne entering and winning the 1901 land lottery, her marriage to Charles Payne and a donation of land to the city of Lawton.

Peace, Jack. "Movies in Lawton." Prairie Lore 17:1 (October 1970): 12-20.

Recollection of the names, places and brief histories of movie theaters in Lawton.

Peace, K. "Growing Up in Comanche County." Prairie Lore 16:4 (April 1980): 234.

Recollection of living in Lawton, about 1916, centering on a herd of cattle that came through the middle of town.

Pokorny, A. F. "A. F. (Tony) Pokorny." Prairie Lore 13:1 (July 1976): 34.

Brief personal history of A. F. Pokorny.

Porter, Joe L. "Joe L. Porter Pioneer." Prairie Lore 6:1 (July 1969): 6-7.

Brief reminiscences of personal activities in early Lawton.

Quinette, W. H. "Early Days at Fort Sill." Prairie Lore 4:3 (January 1968): 171-174.

History of Fort Sill prior to 1901.

_____. "Fort Sill History." Prairie Lore 13:1 (July 1976): 16-19.

Personal recollections of Fort Sill, 1878-1901.

Routh, Audrey Adams. "The Bullfight." Chronicles of Comanche County 1:1 (Spring 1955): 33-34.

An account of the July 1902 bullfight, during Lawton's first street fair; includes a photograph.

Sellars, J. H. Jr. "Boyhood Experiences in Comanche County." Prairie Lore 5:3 (January 1969): 167-169.

Recounts first death experience and related Sunday school experience.

Sizemore, Emery. "Christmas on the Wild Frontiers." Prairie Lore 11:2 (October 1974): 102.

Relates hardships encountered while homesteading during the winter in Comanche County; especially getting supplies.

Smith, George E. "A Homesteader's Story." Prairie Lore 14:3 (January 1978): 188-189.

Arriving and filing for a homestead in Comanche County.

Smith, Thad Jr. "Mrs. Ruth Turpin King." Indian Pioneer Papers 32 (12 April 1937): 316-318.

Relates early memories of Lawton, including her father freighting in town supplies because of the lack of a railroad in early day Lawton.

_____. "Shea Powell." Indian Pioneer Papers 70 (22 April 1937): 325-328.

Recounts being in Lawton during the town lot auction; the lots sold to high to buy, from \$150 to \$2000.

Sneed, R. A. "The Reminiscences of an Indian Trader." Chronicles of Oklahoma 14:2 (June 1936): 135-155.

Memories of a trader for the Comanche, Kiowa and Prairie Apaches at Fort Sill and Anadarko; deals primarily with Fort Sill.

Sprague, Zelpha Carter. "History of the Carter Family." Prairie Lore 16:1 (July 1979): 33-36.

Detailed family history of the Carter family, who lived in Lawton from the early days to about the 1920's.

Stephens, J. M. "J. M. Stephens, Pioneer." Prairie Lore 5:1 (July 1968): 58-59.

Experiences in early day Lawton.

Stevens, W. C. "History of the Great Land Opening." Prairie Lore 8:4 (April 1972): 194-201.

Recounts the opening of Lawton from the county attorney's viewpoint, W. C. Stevens; includes the opening of the First National Bank, duties of the county attorney and other personalities and jobs there in the early days.

Swett, Morris. "Salvaging of Historical Material." Chronicles of Comanche County 1:1 (Spring 1955): 17-20.

Details items of value to the Comanche County Historical Society--private letters, newspapers, diaries, monuments, photographs, old maps and personal experiences--and the saving of many old Fort Sill papers from being disposed of.

Swett, Sergeant Morris. "The Big Prairie Fire." Chronicles of Comanche County 3:1 (Spring 1957): 15-20.

Recollection of the March 1904 prairie fire in Lawton.

Thomas, Bessie L. "Caroline Hansen." Indian Pioneer Papers 92 (25 February 1938): 196-199.

Abbreviated reminiscence of places in Lawton; Diehl Hardware store; the first home built; and the fire that threatened that home.

_____. "Mr. G. E. Cox." Indian Pioneer Papers 100 (21 January 1938): 317-322.

Discusses Union Park and Tourist Park, which were both donated by Mattie Beal Payne. Also discusses the creeks that run through or near Lawton.

Vestal, Ophelia D. "A. B. Kimble." Indian Pioneer Papers 86 (01 April 1938): 436-437.

Discusses arriving in Lawton and buying a town lot, which he continued to own at the time of the interview. Kimble also operated a hardware store in Lawton for six years but the location of the store is not disclosed.

_____. "J. M. Stephens." Indian Pioneer Papers 87 (24 January 1938): 255-258.

Discusses the water supply problem and the fire hazard in early day Lawton. Including the information that the first wagon on the site to fight a fire received five dollars and one building was physically moved a few feet to avoid destruction.

_____. "Mrs. Eva M. Cash." Indian Pioneer Papers 88 (24 January 1938): 178-181.

Recounts early experiences in Lawton; buying three lots and setting up tents on them; fire hazards; building a storm cellar after a tornado destroyed the town of Snyder.

_____. "Mrs. Henry McMillian." Indian Pioneer Papers 102 (02 March 1938): 237-241.

Discusses arriving in Lawton and working in Kress store as a floor walker. While working there, military officers came to the store to insure all people working there were vaccinated for small pox.

Wallace, Jean Lowry. "Memories of Hillside Schools in 1904." Prairie Lore 15:4 (April 1979): 222-223.

Experiences and people at the 1904 Hillside School; located four miles south of Lawton.

Warner, Martha Burton. "Cultural Life of the Last Frontier." Chronicles of Comanche County 2:1 (Spring 1956): 22-23.

Relates organizations that developed in Lawton to form cultural life and names of the organizers and members.

Whalin, H. N. "H. N. Whalin, Land Locator." Prairie Lore 12:4 (April 1976): 234-235.

Recalls experiences of arrival and early days in Lawton; organizing a law firm and working as a "land locator" to locate land claims for others.

"What Lawtonians Were Talking About." Chronicles of Comanche County 1:2 (Autumn 1955): 68.

Excerpts from The Daily Republican, February 1902.

Wright, Frank. "The "Big Pasture"--Past and Present." Chronicles of Comanche County 1:2 (Autumn 1955): 80-84.

Relates the opening of the "Big Pasture", Comanche County, in 1906 and what it had become in 1955. Includes a 1903 map of Comanche County.

Yates, Ethel Mae. "Anna O. Thomas." Indian Pioneer Papers (02 November 1937): 291-296.

Discusses homesteading in Oklahoma Territory and Indian Territory. Although in Lawton during the opening, they were not able to stake a claim, but her husband worked as a claim locator for other people.

Government Documents

Thirteenth United States Census. 1910.

Census records for the United States during the decade ending in 1910.

Fourteenth United States Census. 1920.

Census records for the United States during the decade ending in 1920.

Fifteenth United States Census. 1930.

Census records for the United States during the decade ending in 1930.

Sixteenth United States Census. 1940.

Census records for the United States during the decade ending in 1940.

Seventeenth United States Census. 1950.

Census records for the United States during the decade ending in 1950.

Newspapers

The Daily Oklahoman. Oklahoma City, Oklahoma. 5 June 1902.

Relates the assessed value of Lawton at \$382,873 and a meeting to be held 4 July 1902 to levy taxes.

The Daily Oklahoman. 29 November 1903.

Recounts the improvements Lawton had made since the town opening, including the numerous railroads and industries in the town.

The Daily Oklahoman. 10 June 1938.

Brief article relating Lawton building permits were at an all-time high.

The Lawton Constitution. Lawton, Oklahoma. 5 January 1969.

History of Lawton, including churches, industries and development of the town.

The Lawton Morning Press-Constitution. 6 August 1986.

Recounts what Lawton was like primarily during the 1920's and 1930's. The article was written by W. W. Greb, lifetime Lawton resident.

The Purcell Register. Purcell, Oklahoma. 19 June 1903.

Brief account of developments in the two territories, including Lawton's recent formation of a chamber of commerce.

Secondary

Books

Brown, Kenny. Exploring The Past: Historical Sites in the Lawton Area. Goodwell, Oklahoma: 1979.

Details area attractions around Lawton, designed to be used as a tour book.

Cameron University. Cameron University Catalog 1991-1993. Gilliland Printing, Inc., 1990.

Details the attractions and services of Cameron University, including a brief history of the school from its beginning to present day.

Gibson, Arrell Morgan. Oklahoma: A History of Five Centuries. Norman: University of Oklahoma Press, 1981.

Textbook discussion on Oklahoma from prehistoric times to the present.

Morris, John W. Cities of Oklahoma. Oklahoma City: Oklahoma Historical Society, 1979.

Short essays on the various cities of Oklahoma; including an excellent depiction of the growth and development of Lawton from the 1901 land lottery to the early 1970's.

Murphy, Polly. So Lingers Memory: Fort Sill Post Cemetery Inventories. 1985.

Listing of graves at Fort Sill Main Post Cemetery,
Apache Indian Cemetery, Old Fort Reno Post Cemetery,
Comanche Indian Cemetery at Fort Sill and Comanche
Mission Cemetery, 1869 to 1965.

. The Geronimo Advocate: Births, Marriages and Deaths, Comanche
County, Oklahoma.

Excerpts from the Geronimo Advocate, January 1907 to
November 1912.

Nye, Wilbur Sturtevant. Carbine and Lance: The Story of Old Fort Sill.
Norman: University of Oklahoma Press, 1969.

An excellent detailed book concerning the development
of Fort Sill and the Native American participation in
that development.

Powell, Esther and Ruth Roberson. Lawton, A Child of the Prairie.
Lawton: C and J Printing Co., 1961.

A good history of Lawton aimed at teachers and
children.

Sprague, Robert S. Grass Money. Lawton: Robert S. Sprague, 1970.

Fictional romance story of the 1901 land opening.

Stevens, M. David. Lawton-Fort Sill: A Pictorial History. Norfolk,
VA: Donning Co., 1990.

Illustrates the history of Fort Sill and Lawton. The
bibliography and index may be of use as the book is of
recent publication.

Todd, Joe L. Catalogue of Oral Histories. Oklahoma City: Oklahoma
Historical Society, 1984.

Annotated citations of the Oklahoma Historical
Society's oral history program. Of a possible four
relating to Comanche County three may be of interest:
82.12 Mrs. Josephine Commer, 82.51 Mrs Lillian Harmon
and 83.106 Mrs. Cora Lee King.

The History of Comanche County. Lawton: Southwest Genealogical
Society, 1985.

A slightly romanticized but thorough look at local businesses, churches, schools, organizations and families. The information begins with the opening of the county to comparatively recent times.

Turcheneske, John Anthony. The Apache Prisoners of War at Fort Sill, 1894-1914. Ph.d. diss., University of New Mexico, 1978.

History of the Apache Prisoners of war held at Fort Sill under military jurisdiction from 1894 to 1914.

Articles

"A Law Firm of 1902." Chronicles of Comanche County 2:2 (Autumn 1956): 103.

Brief sketch of Ambrose E. and Homer C. Hammond, Lawton attorneys.

"An Old Lawton Landmark." Chronicles of Comanche County 3:2 (Autumn 1957): 87.

History of the Talley Cottage, 232 B Avenue; condemned 1957 and apparently demolished.

Allen, Iva Williams. "Early Days in Meers." Chronicles of Oklahoma 32:3 (Autumn 1954): 278-289.

Relates happenings of interest in early day Meers; including talk of three wild cats sold to a Lawton saloon keeper who kept the cats in the windows of his saloon.

Allgood, Samuel Y. "Historic Spots and Actions in Washita Valley." Chronicles of Oklahoma 5:2 (June 1927): 221-233.

Relates historic sites and actions in the Washita Valley; including Fort Sill and its predecessor Fort Arbuckle.

Allhands, James L. "History of the Construction of the Frisco Railway Lines in Oklahoma." Chronicles of Oklahoma 3:3 (September 1925): 292-239.

Concerns many of the railroads that traversed Oklahoma largely before statehood. Related to Lawton was the Oklahoma City and Western railroad which connected Oklahoma City and Lawton by August 1902.

Anderson, Ken. "Frank Frantz, 1906-1907." Chronicles of Oklahoma 53:1
(Spring 1975): 128-144.

Story of Frank Frantz, Oklahoma Governor 1906 to 1907;
while in office he mandated that the "Big Pasture" be
bid on rather than holding a run or lottery.

Austin, Gladys Gray. "Across the Years." Chronicles of Comanche County
2:2 (Autumn 1956): 89-94.

History of Mr. and Mrs. Fred Heinz, homesteaders.

_____. "Comanche County, A Bit of History and a Few Facts."
Chronicles of Comanche County 6:2 (Autumn 1960): 73-77.

Brief history of Comanche County--starting in 1542--
and facts and figures from the Comanche County
Commissioners proceedings in the early days.

Balylat, Frank A. "Junior Colleges in Oklahoma." Chronicles of
Oklahoma 26:1 (Spring 1948): 56-62.

Brief history of the Junior Colleges in Oklahoma.
Lawton had three in the 1922-1925 time span; of which
only one continued for any significant length of time--
Cameron State Agriculture College.

Bass, Henry B. "Herbert Hiram Champlain." Chronicles of Oklahoma 33:1
(Spring 1955): 43-48.

Story of H. H. Champlain, businessman in Enid,
primarily, but also owned a lumber yard in Lawton.

Billington, Monroe. "Senator Thomas P. Gore." Chronicles of Oklahoma
35:3 (Autumn 1957): 265-287.

Follows the career of prominent Lawton lawyer, Senator
Thomas P. Gore.

Blochowiak, Mary Ann. "Woman With a Hatchet: Carrie Nation comes to
Oklahoma Territory." Chronicles of Oklahoma 59:2 (Summer 1981):
132-151.

Story of Carrie Nation's visit to Oklahoma Territory,
including her 1905 stop in Lawton.

Brookes, Thelma. "Merritt Julius Glass, 1879-1949." Chronicles of Oklahoma 28:3 (Autumn 1950): 366-368.

Obituary of Merritt J. Glass, attorney in Lawton from 1901 to 1909 when he moved to Tulsa.

Brown, Kenny L. "The Land Lottery of 1901." Prairie Lore 16:1 (July 1979): 2-11.

History of the 1901 land lottery--reasons for, operation of, opening and lottery results, women in.

Brown, Opal Hartsell. "Frontier Honeymoon." Prairie Lore 17:4 (April 1982): 197-202.

Diary/chronology of events from 1867 to 1907; from treaties with the Indians to statehood.

_____. "The Bum's Rush to Lawton." Prairie Lore 16:2 (October 1979): 77-79.

Story of how Aubrey A. Hartsell arrived in Lawton, his stay and eventual departure from Lawton.

_____. "Vanishing Railroad." Prairie Lore 14:3 (January 1978): 160-165.

Tells of the railroad that was suppose to connect Ardmore and Lawton, 1911-1913. It never reached Lawton due to the oil strike west of Ardmore.

Buckingham, Harry. "First Nail Driven on the Lawton Townsite." Prairie Lore 4:1 (July 1967): 6.

First nail driven by J. E. Jarvis.

"Cameron College Blacksmithing Class of 1911." Prairie Lore 8:4 (April 1972): 251.

Photograph of the Blacksmithing class at Cameron College in 1911.

Carter, L. Edward. "Rise and Fall of the Invisible Empire: Knights of the Klu Klux Klan." Great Plains Journal 16:2 (Spring 1977): 82-106.

Story of the KKK in Lawton and Comanche County in the 1920's.

Chaddock, Bob. "Lawton's First Newspaper." Prairie Lore 5:3 (January 1969): 175-179.

Tells of newspapers established in Lawton's first year: predominately The Republican and The Democrat.

Chapman, Berlin B. "Land Office Business at Lawton and El Reno." Great Plains Journal 7:1 (Fall 1967): 1-25.

Details the allocation of land in Lawton and El Reno; includes 1901-1902 map.

"Church Records of Lawton, Oklahoma." Tree Tracers 8:4 (Summer 1984): 23.

A listing of Lawton churches and the date of organization.

Claiborne, Ray. "Hugh Corwin." Prairie Lore 23:1 (April 1987): 2-4.

Posthumous tribute to Hugh D. Corwin.

Corbert, William P. "Rifles and Ruts: Army Road Builders in Indian Territory." Chronicles of Oklahoma 60:3 (Fall 1982): 294-309.

Tells of 19th Century roads built by the Army; includes maps and photographs.

Corwin, Hugh D. "Birthday of the City of Lawton, October 26, 1901." Prairie Lore 7:2 (October 1970): 82-84.

Relates the actions of the county officials prior to the city officials election on October 26, 1901.

_____. "Brigadier General Benjamin H. Grierson." Prairie Lore 6:1 (July 1969): 2-6.

Biography of Brig. Gen. B. H. Grierson's military years before Fort Sill and at Fort Sill.

_____. "Cameron State School of Agriculture." Prairie Lore 12:3 (January 1976): 129-189.

History of Cameron State School of Agriculture during the time period of 1901 to 1927.

- _____. "Early Days of Cameron College." Chronicles of Comanche County 4:1 (Spring 1958): 1-5.

History of Cameron College from 1908 to 1911.

- _____. "Elmer Thomas, 1876-1965." Chronicles of Oklahoma 43:3 (Autumn 1965): 357-359.

Obituary of Elmer Thomas; lawyer, State Senator and United States Senator.

- _____. "First Hospitals of Comanche County." Chronicles of Comanche County 4:2 (Autumn 1958): 93-98.

Traces the development of the Comanche County hospital in Lawton.

- _____. "Music in Early Days of Lawton." Prairie Lore 12:1 (July 1975): 41.

Relates the names of those involved in organizing the early day musical organization--Walkins Orchestra--and a few of their activities.

- _____. "Old Roseland Methodist Church." Prairie Lore 13:3 (January 1977): 156-162.

History of the Roseland Methodist Church, located five miles east of Lawton.

- _____. "Protestant Missionary Work Among the Comanche and Kiowas." Chronicles of Oklahoma 46:1 (Spring 1968): 41-57.

Relates the history of missionary work among the Kiowas and Comanche, including the re-interment of Quanah Parker and Cynthia Ann Parker to the Fort Sill Post cemetery in 1957.

- _____. "Safeway Food Chain Originates in Lawton." Prairie Lore 15:2 (October 1978): 121-122.

O.P. Skaggs owned and operated Skaggs Grocery in Lawton, D and 3rd street, until 1916 when he left Lawton for Idaho, then California; eventually opening the Safeway chain of stores.

Daugherty, Fred A. "Oklahoma's Military Tradition." Chronicles of Oklahoma 57:4 (Winter 1979): 427-445.

Relates the history of the military in Oklahoma from the 1830's to the Vietnam Conflict.

Development Research Associates. "Housing Strategy Lawton, Oklahoma." Lawton Metropolitan Area Planning Commission, 1973.

Details the existing situation and proposed solution for Lawton's housing concerns in the early 1970's.

Doty, Eva and Prairie Lore Staff. "Fort Sill Indian School, 1871-1971." Prairie Lore 8:1 (July 1971): 22-31.

Growth of the Fort Sill Indian School from the 1870's to about the 1950's.

Doyle, Judge Thomas. "Single Versus Double Statehood." Chronicles of Oklahoma 5:3 (September 1927): 266-286.

Discusses the issue of Oklahoma Territory, Indian Territory and statehood. Comanche County is mentioned regarding a half million dollar fund derived from rentals of section 33 in the Cherokee Strip and the counties of Comanche, Kiowa, Caddo and Greer.

"Early Day Officers." Chronicles of Comanche County 2:2 (Autumn 1956): 71-72.

List of those appointed to Comanche County offices in 1901 and the Lawton city officials elected in 1901, as well as 1902 city and county election results.

"Elks Parade and Convention, Lawton Oklahoma June 8, 1910." Prairie Lore 4:3 (January 1968): 130-133.

Discusses the Elks parade and convention at Lawton; includes photographs of the streets.

Ellenbrook, Edward Charles. "Pair's Corner--Circa 1926." Prairie Lore 17:2 (April 1981): 69-74.

Brief history of the Pair family and their 1920's and 1930's landmark service station; located at the southwest edge of town.

Estill, Emma A. "The Great Lottery." Chronicles of Oklahoma 9:4
(December 1931): 365-381.

Details the history of the land lottery--how it came about, the drawing and the sale of town lots in 1901.

Estill-Harbour, Emma "A Brief History of the Red River Country Since 1803." Chronicles of Oklahoma 16:1 (March 1938): 58-88.

Relates the history of the Red River Country, including a synopsis of the history of Fort Sill.

_____. "Greer County." Chronicles of Oklahoma 12:2 (June 1934): 145-162.

Details the dispute over an area of land in Texas and Oklahoma; Fort Sill was involved in the litigation.

Fischer, Leroy H. "Oklahoma Territory 1890-1907." Chronicles of Oklahoma 53:1 (Spring 1975): 3-8.

History of the Oklahoma Territory from 1890 to 1907.

_____. "The Historic Preservation Movement in Oklahoma." Chronicles of Oklahoma 57:1 (Spring 1979): 3-25.

History of the Preservation movement in Oklahoma, including sites and people important to the movement; such as Fort Sill, one of sixteen historic sites that were in the National Historic Landmarks Program as of February 1978.

Foreman, Carolyn Thomas. "General Benjamin Henry Grierson." Chronicles of Oklahoma 24:2 (Summer 1946): 195-218.

History of Gen. Grierson, Fort Sill leader and Indian fighter.

_____. "General William Babcock Hazen." Chronicles of Oklahoma 20:4 (December 1942): 322-342.

Discusses Gen. Hazen, who moved to Fort Sill when it opened; made Colonel of the 6th Infantry on March 15, 1869.

Foreman, Grant. "Early Post Offices of Oklahoma." Chronicles of Oklahoma 6:3 (September 1928): 271-298; 7:1 (March 1929): 7-33.

Lists Post Offices in Oklahoma by city and county.
Also provides the name of the first postmaster and
date of appointment.

_____. "Early Trails Through Oklahoma." Chronicles of Oklahoma 3:2
(June 1925): 99-119.

Discusses the many different trails that ran through
Oklahoma. Included is discussion on the establishment
of Fort Sill, among other sites.

_____. "Historical Background of the Kiowa-Comanche Reservation." Chronicles of Oklahoma 19:2 (June 1941): 129-140.

Details activities with the Indians prior to the
opening of the area to whites in 1901.

Franklin, Jimmie L. "That Noble Experiment: A Note on Prohibition in
Oklahoma." Chronicles of Oklahoma 43:1 (Spring 1965): 19-34.

Discusses Oklahoma's 1906-1911 prohibition and legal
ways of obtaining liquor, "medical dispensaries". A
medical dispensary was located in Lawton.

"From The Lawton Constitution, December 29, 1904." Chronicles of
Comanche County 2:2 (Autumn 1956): 104-107.

Excerpts from The Lawton Constitution, December 29,
1904 and December 21, 1905; The Lawton Daily Star,
June 2, 1908; and the Evening State Democrat, December
22, 1905.

Gage Duane. "Al Jennings, The People's Choice." Chronicles of Oklahoma
46:3 (Autumn 1968): 244-248.

Relates the story of Al Jennings, convicted train
robber. In 1902, when released from prison, he went
to Lawton to practice law. In 1914, he,
unsuccessfully, ran for Oklahoma governor.

Garrett, Jessie Lee Ramsey. "Centenary Methodist Church." Chronicles
of Comanche County 4:1 (Spring 1958): 6-12.

History of the Centenary Methodist Church, north and
south.

_____. "Jesse Denton Ramsey." Chronicles of Comanche County 2:1
(Spring 1956): 8-13.

Personal history of Jesse D. Ramsey, his arrival in Lawton and some of his activities in Lawton.

_____. "Lawton's Early Water Problem." Prairie Lore 1:1 (July 1964): 13-14.

Discusses the lack of water in early day Lawton and some of the early solutions.

_____. "Lawton-Fort Sill Interurban." Chronicles of Comanche County 6:1 (Spring 1960): 2-7.

History of the Lawton street cars which connected Lawton and Fort Sill, 1914 to 1927; includes photographs.

_____. "Mrs. Abe March, Pioneer Woman of Comanche County." Chronicles of Comanche County 2:2 (Autumn 1956): 63-71.

Personal history of Mrs. Abe March, nee Florrie Langham, in the early days of Lawton. Also lists the organizations Mrs. March belonged to.

Garrity, Richard. "End of the Line." Prairie Lore 15:2 (October 1978): 111.

Relates to the Baldwin Steam Engine No. 1526, which is permanently displayed at the Museum of the Great Plains.

Garritys, The. "Lawton--The Early Years." Prairie Lore 17:2 (April 1981): 90-91.

Discusses the opening of Lawton and some of the attractions of the area; railroad, Wichita Forest Reserve, Fort Sill, Meers ghost mining town and Cameron University in Lawton.

Geary, Helen Brophy. "After the Last Picture Show." Chronicles of Oklahoma 61:1 (Spring 1983): 4-27.

History of L. W. Brophy, who owned several movie theaters in Oklahoma; including one in Lawton.

Gettys, Marshall. "Euro-American Historical Archaeology in Oklahoma." Chronicles of Oklahoma 59:4 (Winter 1981-1982): 448-464.

Relates archaeological dig sites in Oklahoma;
including the Mathewson house, the Kiowa Agency and
the Red Store sites in Comanche County.

Gibson, A. M. "Museum of the Great Plains: Purpose and Prospects."
Great Plains Journal 3:1 (Fall 1963): 25-31.

Discusses the purpose and prospects of the Museum of
the Great Plains.

_____. "Research Center: Museum of the Great Plains." Great Plains
Journal 1:1 (Fall 1961): 36-40.

Concerns the 1961 research aids and sources at the
Museum of the Great Plains.

Gill, Jerry L. "Thompson Benton Ferguson, 1901-1906." Chronicles of
Oklahoma 53:1 (Spring 1975): 109-127.

Story of Thompson B. Ferguson, Oklahoma Governor from
1901 to 1906.

Glassman, Colonel (Retired) George. "Mrs. Cecilia Glassman, 1901
Pioneer." Prairie Lore 12:4 (April 1976): 222-225.

Tribute to Col. Glassman's mother, who lived in Lawton
but was primarily a homesteader.

Godlove, Mrs. W. W. "Grand Old Man of Medicine--Ernest Brindley Dunlap,
M.D." Chronicles of Comanche County 3:1 (Spring 1957): 8-11.

Biographical sketch of Ernest B. Dunlap, Lawton
doctor.

Goodin, Barbara. "John Thomas Rogers." Prairie Lore 26:1 (Spring
1990): 49-51.

Personal history of John T. Rogers, pioneer dairyman
in Lawton.

Gould, Charles N. "Beginning of the Geological Work in Oklahoma."
Chronicles of Oklahoma 10:2 (June 1932): 196-203.

Geological survey of the Wichita Mountains, Bulletin
No. 12 of the Oklahoma Geological Survey. Disputes
the presence of gold in any significant amount in the
Wichita Mountains.

"Groceries--Wholesale, Harry Buckingham, 1902-1905." Chronicles of Comanche County 2:2 (Autumn 1956): 95-96.

Activities of Harry Buckingham, wholesale grocerer from 1902 to 1905.

Hale, Duane K. "Gold in Oklahoma: The Last Great Gold Excitement in the Trans-Mississippi West, 1889-1918." Chronicles of Oklahoma 59:3 (Fall 1981): 304-319.

History of gold mining in the Wichita Mountains.

Harper, Richard. "Missionary Work of the Reformed (Dutch) Church in America, in Oklahoma." Chronicles of Oklahoma 18:4 (December 1940): 328-347; 19:2 (June 1941): 170-179.

Relates the history of missionary work among the Comanche and Apache Indians and the white people of Oklahoma.

Historic Sites Committee. "Oklahoma Historic Sites Survey." Chronicles of Oklahoma 36:3 (Autumn 1958): 282-314.

Lists the 550 sites of historical significance in Oklahoma; including ten sites in Comanche County, none in Lawton.

Holland, Reid. "The CCC in Southwest Oklahoma." Prairie Lore 7:2 (October 1970): 108-111.

Discusses the organization of the Federal CCC camps in Southwest Oklahoma and some of their activities. The only all Black CCC camp was located at Fort Sill.

Hollen, W. Eugene. "A Spanish "Arrastra" in the Wichita Mountains." Chronicles of Oklahoma 34:4 (Winter 1956-1957): 443-455.

Discusses the history of gold in the Wichita Mountains and prospecting for the gold, starting in about the 1890's through the early 1900's. No substantial deposits were found.

Howell, Elizabeth. "Old Timer Remember Early Days in Lawton." Prairie Lore 20:2 (October 1984): 2-4.

Brief reminiscences of Hugh Corwin and Ruby Harris of their respective childhoods in Lawton.

Hume, C. Ross. "Historic Sites around Anadarko." Chronicles of Oklahoma 16:4 (December 1938): 410-424.

Among other sites around Anadarko, the article discusses the history of the Comanche, Kiowa and Plains Apache on the Fort Sill Reservation.

Jacobson, O. B. and Jeanne d'Ucel. "Art in Oklahoma." Chronicles of Oklahoma 32:3 (Autumn 1954): 263-277.

Discusses artists who have painted in Oklahoma; including the late 19th Century painters Frederick Remington and Elbridge Ayer Burbank. Both of these artists painted at Fort Sill.

"Jesse Albert Baker." Chronicles of Oklahoma 8:4 (December 1930): 460.

Obituary of Jesse Albert Baker, attorney, who located at Lawton during the opening. Born 1853, died 1930.

Jeter, Jerry B. "Pioneer Preacher." Chronicles of Oklahoma 23:4 (Winter 1945-1946): 358-368.

Brief history of E. B. Jeter, missionary and doctor in Lawton. He helped remove the Comanche funeral plots located in the Lawton city limits, after the city demanded removal of them in 1903.

"John F. Thomas, Lawyer, One out of 148." Chronicles of Comanche County 2:1 (Spring 1956): 42.

Brief history of John Thomas and some of his 1956 observations. In 1956, he was the only active lawyer still living in Lawton of the 148 listed in the 98 law offices of 1902.

"John Jones Grocery." Prairie Lore 9:4 (April 1973): 253.

December 1925 photograph of the J. Jones grocery store, located at 612 D. Avenue, Lawton.

Kelly, Leonora. "Jake Talmadge, Lawton Pioneer." Prairie Lore 13:1 (July 1976): 30.

Personal history of Jake Talmadge.

King, Jane L. "Mollie Randolph, Lawton Pioneer." Prairie Lore 12:2 (October 1975): 79.

Brief personal history of Mollie Randolph, primarily dealing with Fort Sill; although M. Randolph did keep statistics of deaths and births in Lawton for twenty-eight years.

"Land Drawing Postcard." Prairie Lore 6:3 (January 1970): 153.

Photograph of notice of result of the drawing at El Reno.

Laurey, Mildred Cox. "William Bennett Cox--Comanche County Pioneer." Prairie Lore 12:4 (April 1976): 236.

Personal history of William B. Cox, by his daughter.

Lawrence, Arthur R. "A Brief History of the Original Red Store." Chronicles of Comanche County 6:2 (Autumn 1960): 59-68.

Short history of the early Red Store and trade with the Indians. Also includes history of the store through the 1920's when it was located in Lawton at 131 C Avenue.

_____. "In 1907 Oklahoma Becomes a State." Chronicles of Comanche County 3:2 (Autumn 1957): 66.

Brief look at Lawton at the time of statehood.

_____. "Our Accessions--Their Background and History." Chronicles of Comanche County 1:1 (Spring 1955): 21-26.

Details the items accessioned by the Comanche Historical Society.

Lawrence, Mr. and Mrs. James. "If I Had My Life to Live Over Again." Chronicles of Comanche County 3:2 (Autumn 1957): 81-87.

Personal history of Mr. Kellye Johnstone, early settler.

Lawton Constitution. "Arthur Lawrence, Lawton Historian." Prairie Lore 17:4 (April 1982): 194-196.

Posthumous tribute to Arthur Lawrence, city historian.

_____. "Charles C. Black, Pioneer Lawton Attorney." Prairie Lore 8:3 (January 1972): 179-180.

Personal history of Charles C. Black, attorney. He was city attorney from 1911 to 1913 and editor/manager of the Lawton News-Republican from 1914 to 1915.

"Lawton Directory." Chronicles of Comanche County 2:2 (Autumn 1956): 73-77.

Excerpts from the 1902 Lawton directory.

"Lawton High School Publication, The Tomahawk." Chronicles of Comanche County 2:2 (Autumn 1956): 88.

Excerpts from the 1905 Tomahawk.

Lehman, Leola. "It was Law Versus Outlaw in Lawton." Prairie Lore 3:4 (April 1967): 219-223.

Concerns the trial of members of the Bert Casey gang for murder of Beenblossom; includes a photograph of early day Lawton.

Leininger, Bill. "The Opening of Lawton." Prairie Lore 3:3 (January 1967): 160-168.

Romanticized look at Henry Leininger's family's move to Lawton.

Lewis, Dr. Anna. "Trading Post at the Crossing of the Chickasaw Trails." Chronicles of Oklahoma 12:4 (December 1934): 447-453.

Primarily discusses the "Boggy Depot" trading post and the stage line that ran through there, Fort Sill and beyond.

"Louis Davis." Chronicles of Oklahoma 20:1 (March 1942): 100.

Obituary of Louis Davis, April 1859-June 1912. Davis was a Lawton lawyer from 1902 to 1907 and Commissioner of the State Bar from 1907 to 1911.

Lowry, Aline. "William Charles Lowry." Prairie Lore 6:2 (October 1969): 99-104.

Relates the story of W. C. Lowry coming to Lawton and homesteading in Comanche County.

Maddux, Frances Madera. "Marriage Licenses 1901-1902." Chronicles of Comanche County 2:1 (Spring 1956): 43-51.

List of Comanche County Court House records of marriage licenses issued in 1901 to 1902.

_____. "Marriage Licenses 1903." Chronicles of Comanche County 2:2 (Autumn 1956): 108-117.

List of 1903 marriage licenses from the Comanche County Court House records.

_____. "Marriage Licenses." Chronicles of Comanche County 3:2 (Autumn 1957): 104-114; 4:1 (Spring 1958): 56-61; 5:1 (Spring 1959): 42-48; 5:2 (Autumn 1959): 92-97; 6:1 (Spring 1960): 44-47.

List of Comanche County Court House records of 1904 and 1905 marriage licenses.

Malcolm, Dwight. "Dr. John W. Malcolm, Pioneer Lawton Doctor." Prairie Lore 8:3 (January 1972): 159-161.

Personal history of one of the first doctors in Lawton and early experiences in Lawton; including a mix up involving the "south" and "north" Methodist churches.

McClung, Paul. "Half-Century in Show Business." Prairie Lore 17:4 (April 1982): 215-217.

Tribute to Mildred Chrisman, rodeo cowgirl and performer.

_____. "Newspaper Part of History." Prairie Lore 19:2 (April 1983): 27-28.

Excerpts from Lawton newspapers in Lawton's first decade of existence.

_____. "What is Lawton America About?" Prairie Lore 23:1 (October 1986): 51-54.

Illustrates Lawton is "American"--many different cultures and lifestyles.

Mellinger, Phillip. "Discrimination and Statehood in Oklahoma." Chronicles of Oklahoma 49:3 (Autumn 1971): 340-378.

Discusses the status of Blacks in Oklahoma primarily before statehood, although there is mention of after statehood. Includes the 1902 race riot in Lawton.

Mitchell, Sara Brown. "The Early Days of Anadarko." Chronicles of Oklahoma 28:4 (Winter 1950-1951): 390-398.

Early days in Anadarko, county seat of Caddo County. It was opened in 1901 in the drawing with Lawton.

Mooney, Charles W. "Ghost Town: McGee, Indian Territory." Chronicles of Oklahoma 47:2 (Summer 1969): 160-167.

Story of the town of McGee which disappeared due to the railroads demand for money. Includes a brief history of Whit Hyden, surveyor of Lawton.

Moore, Colonel Horace L. "The Nineteenth Kansas Cavalry in the Washita Campaign." Chronicles of Oklahoma 2:4 (December 1924): 350-365.

Discusses the Native American and U. S. cavalry actions, which were causation for the establishment of Fort Sill.

Morrison, W. B. "Colbert Ferry on the Red River, Chickasaw Nation, Indian Territory." Chronicles of Oklahoma 16:3 (September 1938): 302-314.

Recounts the recollections of John Malcolm, ferryman during the pioneer years. Mentions Fort Sill as to where they got their supplies--hauling them from Colbert Station to Caddo.

Nelson, Guy. "The School Lands of Oklahoma." Chronicles of Oklahoma 46:3 (Autumn 1968): 293-311.

Relates the school land issue; 375,000 acres of land were reserved for "common schools".

"Notes" Chronicles of Oklahoma 17:3 (September 1939): 341-342.

From the August 7, 1939 Lawton Constitution: 1901 City founders gathered at Union Park all day to recall the events of the past thirty eight years.

"Notes from a 1903 Booklet." Chronicles of Comanche County 2:2 (Autumn 1956): 97.

List of prominent Lawton pioneers who contributed to a 1903 booklet.

Nye, Lieutenant Wilbur S. "Annual Sun Dance." Chronicles of Oklahoma 12:3 (September 1934): 340-358.

Discusses Indian like for tropical fruit after being exposed to them at various Forts and, specifically, at Fort Sill after a trader brought in bananas. Also discusses the end of the Kiowa Sun Dance after the threats of the soldiers in 1889.

Ogden, Frances Robertson. "1906--Rol Robertson's Story of Lawton, Oklahoma Territory." Chronicles of Comanche County 4:2 (Autumn 1958): 78.

Experiences of Rol Robertson in Lawton in 1906 and his personal history as a Lawton businessman.

Oley, George N. "New Deal for Oklahoma's Children." Chronicles of Oklahoma 62:3 (Fall 1984): 296-309.

Details Federal action during the 1930's and 1940's regarding child care predominately. This included setting up fifteen nurseries for children, one at Lawton.

Peace, K. "The Hedlund Legacy." Prairie Lore 16:1 (April 1980): 249-252.

Memories of Ephraim Hedlund, janitor at Lincoln Elementary school. His will established a fund to give children candy through the P. T. A. organization.

Peery, Dan W. "General Hugh L. Scott." Chronicles of Oklahoma 13:3 (September 1935): 355-356.

Brief biography of General Hugh L. Scott, commander at Fort Sill.

_____. "The Kiowa's Defiance." Chronicles of Oklahoma 13:1 (March 1935): 30-36.

Story of Satank and Satanta; their raids, arrest and subsequent death of Satank near Fort Sill.

Pennington, William D. "The Oklahoma Delegation to the Democratic Convention of 1924." Chronicles of Oklahoma 62:4 (Winter 1984-1985): 408-419.

Discusses problems of the 1924 Oklahoma delegation; primarily resulting from pro and anti Klu Klux Klan sentiments.

Pettyjohn, Thelma. "Biography of Hugh D. Corwin." Prairie Lore 20:1 (April 1984): 2-4.

Personal history of Hugh D. Corwin, well known writer of Oklahoma history.

"Pioneer Corner." Chronicles of Comanche County 4:1 (Spring 1958): 49-53.

Brief biographical sketches of Reverend and Mrs. F. M. Dykes, Mr. and Mrs. C. L. Hollem and Mr. and Mrs. Frank Rice; all were early Comanche County settlers.

"Pioneer Corner." Chronicles of Comanche County 4:2 (Autumn 1958): 113-120.

Brief biographical sketches of early Comanche County settlers; Mr. and Mrs. H. W. Hanna written by Gladys Gray Austin; Samuel A. Joyner by Morris Swett; and George W. Guthrie by L. R. Guthrie and E. G. Seville.

"Pioneer Corner." Chronicles of Comanche County 5:1 (Spring 1959): 19-25.

Brief biographical sketches of Flossie Turner Taylor by Flossie Turner Taylor, Wilbur Benson Scott by Hugh D. Corwin and Mr. and Mrs. Walter E. Norvell by Gladys Gray Austin; all were early Comanche County settlers.

"Pioneer Corner." Chronicles of Comanche County 5:2 (Autumn 1959): 83-90.

Brief biographical sketches of early Comanche County settlers; Mr. and Mrs. Elton R. Kerby by Martha Burton Warner; Mr. and Mrs. Fred C. Kluck by Hugh D. Corwin; Six Generations in Oklahoma by Marcia Purcell Ruppel-- a family history of Marcia P. Ruppel's family.

Porter, Delmer W. "William Miller Jenkins, 1901." Chronicles of Oklahoma 53:1 (Spring 1975): 83-92.

Story of William M. Jenkins, governor of Oklahoma from May 13, 1901 to November 30, 1901.

Rehkopf, Genevieve Crosby. "Jennett Smith Crosby--A Remarkable Woman." Prairie Lore 16:2 (October 1979): 85-91.

Personal history of Jennett S. Crosby; her arrival in Lawton in 1908 and her schooling.

"Reverend Evan Dhu Cameron." Chronicles of Oklahoma 11:2 (June 1933): 740-743.

Obituary of Reverend Evan D. Cameron, 1862-1933. Rev. Cameron was important in the religious community of Oklahoma and in the establishment of Oklahoma schools. Cameron School of Agriculture at Lawton, opened for receiving students in 1908, was named in his honor.

"Robert J. Ray." Chronicles of Oklahoma 9:4 (December 1931): 485-486.

Obituary of Robert J. Ray, 1864-1931, Lawton pioneer.

Robinson, Gilbert L. "Transportation in Carter County, 1913-1917." Chronicles of Oklahoma 19:4 (December 1941): 368-376.

Relates to the Oklahoma, New Mexico and Pacific Railroad, which was suppose to be built to Lawton but, due to an oil strike in Ardmore, it never reached Lawton.

Routh, Audrey. "Historical Significance of Lawton's Carnegie Library." Lawton Heritage News 1:2 (Autumn 1976): 1-2.

Relates the development of the Carnegie Library in Lawton.

Routh, Audrey Adams. "History of Ownerships--The Mattie Beal Home." Prairie Lore 23:1 (October 1986): 38-40.

History of the Lawton Heritage Association's ownership of the Mattie Beal home. There have been six owners of the home.

_____. "Lawton's First Christmas, 1901." Prairie Lore 24:2 (Fall 1988): 81-89.

Discusses the development of Lawton from the August opening to December, 1901--five months; includes photographs from the J. A. Adams Family Collection of Lawton.

_____. "The Mahoney-Clark House." Prairie Lore 20:2 (October 1984): 53-57.

A history of the Phillip Clark house, how the Lawton Heritage Association obtained it and some of the repairs necessary to stabilize the house.

Shepler, Ned. "The Newspapers as a Record of History." Chronicles of Comanche County 1:1 (Spring 1955): 12-16.

Concerns keeping newspapers as a viable record of history. Primarily deals with The Lawton Constitution, which all the available early Lawton newspapers microfilmed.

Shirk, George H. "First Post Offices Within the Boundaries of Oklahoma." Chronicles of Oklahoma 26:2 (Summer 1948): 179-244; 30:1 (Spring 1952): 38-104.

Expands on Grant Foreman's earlier articles on Post Offices in Oklahoma--Chronicles of Oklahoma 6:1-4 (1928); 7:1 (1929). Lists first postmaster, date of appointment and location.

_____. "The Post Offices of Oklahoma: November 26, 1907-December 21, 1965." Chronicles of Oklahoma 44:1 (Spring 1966): 31-90.

Continuation and update of George Shirk's previous article concerning Oklahoma Post Offices.

Smith, Emily B. "Swanson County." Chronicles of Oklahoma 9:4 (December 1931): 412-422.

Details the controversy of Swanson County, created from Kiowa and Comanche counties, August 1910. Snyder was the county seat. Swanson County was disallowed due to an insufficient number of votes from Comanche County in June 1911.

Steele, Aubrey L. "The Beginning of Quaker Administration of Indian Affairs in Oklahoma." Chronicles of Oklahoma 17:4 (December 1939): 364-392.

Discusses, primarily, the Kiowa, Apache and Comanche agencies in Oklahoma under the guidance of Colonel W. B. Hazen and then Lawrie Tatum; Tatum was a Quaker. Includes incidents of Indian trouble on and off the reservation and Fort Sill's involvement in settling the trouble.

Stewart, Ray P. "Raymond S. McLain: America's Greatest Citizen Solider." Chronicles of Oklahoma 59:1 (Spring 1981): 4-29.

Biographical sketch of Ray McLain; including time he spent at Fort Sill following World War II.

Swett, Morris. "Al J. Jennings." Chronicles of Comanche County 6:2 (Autumn 1960): 82-88.

History of Al J. Jennings, train robber.

_____. "Charles Samuel Thomas." Chronicles of Comanche County 4:1 (Spring 1958): 13-17.

Personal history of Charles S. Thomas, 1901'er and livery business owner and operator.

_____. "Sergeant I-See-O, Kiowa Indian Scout." Chronicles of Oklahoma 13:3 (September 1935): 341-354.

Story of I-See-O, an Indian scout that served and lived at Fort Sill.

Tague, Carl. "Bits and Pieces from Early Day Lawton." Prairie Lore 26:2 (Fall 1990): 83-87.

Personal history of John N. Tague; the opening of Lawton and associated problems, especially water.

"That First Telephone." Chronicles of Oklahoma 14:2 (June 1936): 222.

Discusses the first telephone in Oklahoma; Fort Sill 1881. The first Oklahoma telephone company was started in 1886.

Thoburn, Joseph B. "Horace P. Jones, Scout and Interpreter." Chronicles of Oklahoma 2:4 (December 1924): 380-391.

Recounts the life history of Horace P. Jones, well known military scout and interpreter at Fort Sill.

Tilton, Nellie Wolverton. "Comanche County's First Elected Sheriff." Chronicles of Comanche County 2:1 (Spring 1956): 24-25.

Brief history of C. C. Hammonds, Comanche County's first elected sheriff; elected in spring of 1902.

_____. "Descendants Holding Original Townsite Lots." Chronicles of Comanche County 2:1 (Spring 1956): 40-41.

Shows which town lots are still in the family of the original purchaser's, in 1956, by comparing contemporary owners to those on the 1902 tax roll.

_____. "In Retrospect--1901-1959--Joseph L. Porter." Chronicles of Comanche County 5:2 (Autumn 1959): 67-72.

Story of Joseph L. Porter, early settler.

_____. "Lawton Public Schools 1901-02-03." Chronicles of Comanche County 4:2 (Autumn 1958): 83-89.

Discusses the organization and early development of the Lawton public schools; includes two photographs, the Junior class of 1902 and school officials in front of the 1902 High School building.

_____. "The Black Story." Chronicles of Comanche County 2:1 (Spring 1956): 38-39.

Personal and family history of Charles Columbus Black, 1853-1933.

Vernon, Walter N. "Methodist Beginnings Among Southwest Oklahoma Indians." Chronicles of Oklahoma 58:4 (Winter 1980-1981): 392-411.

History of the Methodist church in Southwest Oklahoma until about 1900.

Ware, James. "Soldiers, Disasters and Dams: The Army Corps of Engineers and Flood Control in the Red River Valley, 1936-1946." Chronicles of Oklahoma 57:1 (Spring 1979): 26-33.

Discusses primarily the Army Corps of Engineers' proposals and actions to control the Red River; including a study that called for irrigation projects west of a line running through Wichita Falls and Lawton.

Warner, Mrs. Martha. "'There's Gold in Them 'Thar Hills'." Chronicles of Comanche County 3:1 (Spring 1957): 12-14.

Family history of the Patterson family; goldseekers in the Wichitas. They lived on Silk Stocking Row in Lawton while their mountain home was being built.

Warner, Martha Burton. "This Was Lawton." Chronicles of Comanche County 1:1 (Spring 1955): 5-11.

Interview of Mrs. Warner by Arthur Lawrence concerning family and personal history; arriving in Lawton and early jobs--running an "eating place" and playing music at dances.

Warner, Richard S. "Barbed Wire and Nazilagers." Chronicles of Oklahoma 64:1 (Spring 1986): 37-67.

History of Nazi prisoner of war camps in Oklahoma during World War II, including one at Fort Sill.

Weedman, V. A. "Lawton." 17 April 1936.

A brief review of the geography, industries and resources, area attractions, churches, educational opportunities and prominent people in Lawton by 1936.

Weller, Mira McClure. "A Daughter's Tribute to Her Parents." Chronicles of Comanche County 3:2 (Autumn 1957): 97-101.

Family history of the McClure family; arrived in Lawton in 1909.

Williams, T. B. "Leslie P. Ross." Chronicles of Oklahoma 23:4 (Winter 1945-1946): 417-418.

Obituary of Leslie P. Ross, 1863 to 1944, first mayor of Lawton.

Williamson, Elizabeth. "Noted Indians of Comanche County." Prairie Lore 5:4 (April 1969): 219-222.

Brief history of noted Indians in the area; Geronimo, Quanah Parker, etc.

Willibrand, W. A. "German in Okarche, 1892-1902." Chronicles of Oklahoma 28:3 (Autumn 1950): 284-291.

Story of Catholic Father Zenon Steber. Father Steber built a church in Lawton, among other places in Oklahoma.

Wilson, Steve. "Documenting Our Heritage Manuscript Collections of the Museum of the Great Plains." Great Plains Journal 17 (1978): 2-24.

Discusses what is in the Museum of the Great Plains' manuscript collection.

Wise, Donald A. "Bird's Eye View of Oklahoma Towns." Chronicles of Oklahoma 67:3 (Fall 1989): 228-247.

Collection of promotional maps drawn from overhead viewpoint; includes Hathaway's bird's eye view of Lawton.

Wright, Muriel H. "General Douglas H. Cooper." Chronicles of Oklahoma 32:2 (Summer 1954): 142-184.

Story of Gen. Cooper, who in 1858 recommended the site of Fort Sill for a military installation.

Zwink, T. Ashley. "On the White Man's Road: Lawrie Tatum and the Formative Years of the Kiowa Agency, 1869-1873." Chronicles of Oklahoma 56:4 (Winter 1978-1979): 431-444.

Early years of the Kiowa Indian agency near Fort Sill.

Unpublished Material

Carter, L. Edward. Voices from the Short Grass Country: a History of Lawton Newspapers, 1901-1970. Ph.D. diss., Oklahoma State University, 1974.

Excellent in-depth discussion of the history of the newspaper industry in Lawton. The information, divided by decades, concerns all major happenings and developments in Lawton as effected by or affecting the newspaper industry.

Collins, Monta Rae. The History of the City of Lawton, Oklahoma. M. A. thesis, Oklahoma University, 1941.

Discusses the development of Lawton from the sale of town lots to World War I.

History of Lake Lawtonka. Lawton, OK; 1957.

Relates the development of Lake Lawtonka, Lawton's main water source.

Reynolds, Estill Clem. History of Fort Sill, Lawton, Oklahoma. M. S. thesis, Oklahoma University, 1930.

Primarily concerns Native Americans and Fort Sill.
Also illustrates the importance of the school of
artillery and, therefore, Fort Sill.

Southward, Claude. A History of Comanche County M. A. thesis, Oklahoma
University, 1929.

Discusses the development of Comanche County and Fort
Sill after the land was opened to white settlement.

Newspapers

"The Lawton-Fort Sill Answer Book." The Lawton Constitution Friday, 30
June 1989.

The supplement contains general information regarding
the Lawton-Fort Sill area. Maps of the important
sites in Lawton may be useful; otherwise not overly
applicable as it is composed of primarily contemporary
information.

The Morning Press. Lawton, Oklahoma. 3 February 1983.

Discusses the project to get the Old Town North
district listed on the National Register of Historic
Places.

The Sunday Constitution. Lawton, Oklahoma. 30 June 1991.

Recounts the history of City National Bank and its
position in Lawton history.

The Sunday Constitution. 11 August 1991.

Relates the location and brief history of all the
elementary schools located in Lawton.

Other

Baker, Arlene et al. "History of the Old Town North Neighborhood
Lawton, Oklahoma." Unpublished pamphlet, "Old Town North
District" file, Oklahoma Landmarks Inventory, Oklahoma Historic
Preservation Office.

An abbreviated history of the Old Town North
Neighborhood. The Old Town North Neighborhood
consists of the 1908 North Addition.

"Facilities Inventory." Grounds Department. Cameron University.
19 June 1992.

A listing of all the buildings on Cameron University
at this time. Includes dates of construction.

Lawton Vertical File. "History of the Lawton Public Library."

Details the founding of a public library in Lawton.

Lawton Vertical File. "The Downtown that Disappeared." Lawton
Constitution.

Lists all the businesses in the downtown area prior to
1965. Includes a map.

"The City of Lawton Fire Rescue." Unpublished pamphlet
available from Lawton Fire Department.

A good detailed history of the development of the
Lawton fire department from 1901 to 1990.

ENDNOTES

1. Monta Rae Collins, "The History of the City of Lawton, Oklahoma". (M.A. thesis, Oklahoma University, 1941), 15.
4. Robertson Realty Company, Lawton, The Wonder City of the Wonder Section, Oklahoma, (St. Louis, MO; Enterprise Addressing Co., 1908), 10. See also Arrell Morgan Gibson, Oklahoma: A History of Five Centuries (Norman: University of Oklahoma Press, 1981), 181.
3. Robertson Realty, 10.
4. Ibid, 10-11. See also Lawton, The Wonder Young City--Capitol of Comanche, the Wonder Young County of the Wonder Young State, Oklahoma, n.p., 1906.
5. Audrey Adams Routh, "Lawton's First Christmas, 1901," Prairie Lore 24 (Fall 1988): 81.
6. Collins, 12. See also Robertson Realty, 11.
7. Arlene Baker et al., "History of the Old Town North Neighborhood Lawton, Oklahoma". Unpublished pamphlet, "Old Town North Historic District" file, Oklahoma Landmarks Inventory, Oklahoma State Historic Preservation Office.
8. Development Research Associates, "Housing Strategy Lawton, OK," (Lawton Metropolitan Area Planning Commission, 1973).
9. Thirteenth United States Census, 1910.
10. Fourteenth United States Census, 1920.
11. Fifteenth United States Census, 1930.
12. Sixteenth United States Census, 1940.
13. Seventeenth United States Census, 1950.
14. The Lawton Sunday Constitution, Lawton Oklahoma, 11 August 1991.
15. Edward L. Curtis, "Voices from the Short Grass Country: A History of Lawton Newspapers, 1901-1970," (Ph.D. diss., Oklahoma State University, 1974), 146, 157.
16. United States Census, 1910, 1920, 1930, 1940, 1950.
17. Collins, 26-29.
18. Collins, 44-45. See also Mrs. S. W. Aurrell, "Early Days in Lawton," Prairie Lore 11 (October 1974): 81-82; and Jessie Lee Ramsey Garrett, "Lawton's Early Water Problem," Prairie Lore 1 (July 1964): 13-14.
19. John W. Morris, Cities of Oklahoma (Oklahoma City: Oklahoma Historical Society, 1979), 92. See also Collins, 44-54 and Claude Southward, "A History of Comanche County," (M. A. thesis, Oklahoma University, 1929), 97-98.
20. Lawton, The Wonder Young City.

21. Baker et al., 6.
22. Southward, 98-99. See also Lawton, The Wonder Young City.
23. Smith, Thad Jr., "Mrs. Ruth Turpin King," (Indian Pioneer Papers, 32 12 April 1937), 316-318.
24. Collins, 94-95.
25. James L. Allhands, "History of the Construction of the Frisco Railway Lines in Oklahoma," Chronicles of Oklahoma, 3 (September 1925): 229-239.
26. The (Oklahoma City) Daily Oklahoman, 29 November 1903.
27. Opal Hartsell Brown, "Vanishing Railroad," Prairie Lore 14 (January 1978): 160-165.
28. Jessie Lee Ramsey Garrett, "Lawton-Fort Sill Interurban," Chronicles of Comanche County, 6 (Spring 1960), 2-7. See also Robertson Realty Company, 15.
29. The Daily Oklahoman, 29 November 1903.
30. V. A. Weedman, "Lawton", 17 April 1936. See also Arthur Lawrence, Lawton Golden Anniversary, 1901-1951, (Lawton, OK; n.p., 1951); 1941 Lawton City Directory; 1946 Lawton City Directory; Michael Hilderbrand, conversation with author, 8 July 1992.
31. Collins, 110.
32. "Lawton," Vertical file, Lawton Public Library.
33. Morris, 96.
34. Oklahoma Landmarks Inventory files, Oklahoma State Historic Preservation Office, Oklahoma City.
35. The Sunday Constitution 11 August 1991.
36. Cameron University, Cameron University Catalog 1991-1993, 9.
37. "Facilities Inventory," Grounds Department, Cameron University, 19 June 1992.
38. "Lawton," Vertical file, Lawton Public Library.
39. Audrey Routh, "Historical Significance of Lawton's Carnegie Library," Lawton Heritage News, 1 (Autumn 1976): 1-2.
40. "The City of Lawton Fire Rescue," unpublished pamphlet available from Lawton Fire Department.
41. Helen Bixby, "Prairie Fire," Chronicles of Comanche County 1 (Spring 1955): 38-39.
42. "The City of Lawton Fire Rescue."
43. Morris, 93-94.

APPENDIX

ARCHITECTURAL REVIEW
OF THE
RECONNAISSANCE LEVEL SURVEY
OF A PORTION OF
LAWTON, OKLAHOMA

Submitted by:

Jeffrey K. Williams, AIA
Associate Professor of Architecture
Oklahoma State University

Submitted to:

Dr. Bill Bryans
Professor of History
Oklahoma State University

It has long been believed by historians, archeologist, architects and others that architecture, our built environment, records the values of our society in physical form. Through architecture we are able to better understand what areas particular cultures have considered worthy of their time, money and effort. We can make observations as to their situation, their goals, their priorities, their spirit, their sophistication, etc. This has also proven true with individual communities and their architecture. The community of Lawton, Oklahoma presents an interesting case in this regard.

Lawton's general physical pattern of growth appears to be similar to that of most southern plains cities. This growth was sustained in the early years due to Lawton's proximity to both Fort Sill and two intersecting railroad lines. Having been designated the status of county seat also aided the early stability of the town. Considering this history it is easy to see the growth pattern of the original town radiating outward from the railroad hub, primarily to the west and north.

The architecture that remains from this period of the town's history is one of a community slowly developing into a place of respectability. The earliest residences, concentrated in the areas north and northwest of the downtown, were buildings of common charm. For the most part their materials were modest, and each attempts to personalize itself with unique details. There is also a great variety of styles represented for such a concentrated area (for example, the native stone bungalows such as the Kilpatrick House, 1608 Arlington and 920 6th Street; the mission style bungalows of the Leslie Powell House and 1115 E Avenue; the wood framed, Victorian detailed 912 B Avenue; and the brick Georgian examples found at the Montgomery House, the English House, and the Quinette House, to name just a few). It is interesting to note that while most of these residences were modest, they could exist in direct proximity to a stately Italianate residence of the stature of the Mattie Beal House.

The examples of public and/or civic architecture which remain from this period are not near as conclusive. We can certainly see random examples of

fine schools such as Lincoln School, with its brick Prairie Style influences, and Central Junior High with its stately brickwork and dome. We can also see energetic masonry park structures such as the WPA Bridge at 11th and Park Avenue, with its uniquely Gothic influence, and the portal park entry at 13th and Bell. Fine examples of Classicism exist in structures such as the Carnegie Library and the Federal Building, which utilize their architectural vocabulary to designate their stature in the community. Yet there are very few remains of the early commercial architecture. Of note are the brick two-part commercial block of the J.M. Jones Building and the brick one-part commercial block of Sasser's Grocery and Market. While these do not stand out as premier examples of this architectural type, they are the only remaining examples of this building type from the town's early history. Furthermore, it should be noted that there remain no examples from this period of landmarks such as government buildings and banks, those building types which typically provide a physical anchor for the secondary buildings of the community. Because of this the community is missing a significant part of its physical history.

This is due to the city's development after World War II. During this time the city grew very rapidly (in an effort to accommodate the doubling of its population). As in most communities where this type of growth occurs, the priority is placed on rapid, rather than quality development, and there are very few examples of quality building from this period. Caught up in this process of "progress," and encouraged by government, planners and architects of the time, the city embarked on an urban renewal plan in the 1960's (as did many other prosperous cities of this time). As was typical, the result was the demolition and rebuilding of the city core. This accounts for the loss of the historical landmarks such as the banks, government and commercial buildings. These were the areas where parcels of land could be accumulated in order to facilitate such a large scale venture.

Another building type which managed to escape this development was that of religious structures. Spread throughout the town, it is in this building

type that we can see some of the richest, most elaborately detailed architecture of Lawton. Starting with the older Saint Andrews Episcopal Church, with its energetic and enthusiastic employment of a craftsman-type Gothic, and the Beal Heights Presbyterian Church, with its native stone construction which utilizes Gothic forms but not Gothic proportions, we see a spirited congregation which was very concerned with establishing a permanent home. The elaborate wooden Victorian tracery of the First Presbyterian Church, and the Italianate influence of the Blessed Sacrament Catholic Church continue this effort in a more sophisticated manner, and even the simple early Modern brickwork of the First Church of the Nazarene exemplifies this concern.

In considering the study area as a whole, the most significant historical issue which stands out is the lack of significant commercial and governmental structures. This creates a substantial void in the physical history of the city. Because of this, the concentration of residential structures to the north of the downtown take on a much more important role than normal in recording the spirit of the times, and all possible efforts should be used to ensure the preservation of this aspect of the community's history. With respect to other building types the city's religious and educational structures represent the most comprehensive lineage of built history.